



**S.p.A. BREVETTI INTERNAZIONALI** **CAMPAGNOLO**

**36100 VICENZA - ITALY**  
**CORSO PADOVA, 168**

**TELEFONI: 28985 (4 linee con ricerca automatica)**  
**TELEGRAMMI: CAMPAGNOLO - VICENZA**  
**TELEX : 48074 CAMPA**

All **CAMPAGNOLO** products  
are distinguished by trade marks



PERFECT EFFICIENCY - LONG LIFE - ABSOLUTE GUARANTEE

# ***IMPORTANT !***

---

Orders will not be accepted if the requested articles are not supplied complete with their pertaining CATALOGUE NUMBERS

The present catalogue cancels all previous ones.

Messrs. Brevetti Internazionali Campagnolo S.p.A. reserve the right to alter or improve specifications without prior notice.

RECORD ROAD COMPLETE ENSEMBLE	4-5
RECORD TRACK COMPLETE ENSEMBLE	6-7
NUOVO RECORD GEAR AND RECORD FRONT CHANGER	8-9
VALENTINO EXTRA GEAR AND VALENTINO FRONT CHANGER	10-11
SPORT EXTRA GEAR	12
VALENTINO CONTROL LEVER SYSTEMS	13
RECORD CONTROL LEVER SYSTEMS	14-15
RECORD HUBS	16-17
NUOVO TIPO HUBS	18-19
RECORD BOTTOM BRACKET AND CHAINWHEEL SET	20-21
SPECIAL COTTERLESS CHAINSETS	22-23
BOTTOM BRACKET SET	24-25
RECORD HEAD SET	26
RECORDS PEDALS	27
RECORD BRAKES	28-29
SEAT PINS	30
GUIDES - CABLES - CLIPS	31
QUICK RELEASE SEAT CLIPS	32
FRONT AND REAR FORK ENDS	33
PUMP ADAPTORS - ACCESSORIES - GREASE	34
PUMP HOLDERS AND SPECIAL CONNECTORS	35
SPECIAL TOOLS	36-37
TOOLS CASE AND BICYCLE STAND	38-39
TANDEM CHAIN LINES AND GEAR TABLES	40-41-42

# 1032 - CAMPAGNOLO RECORD

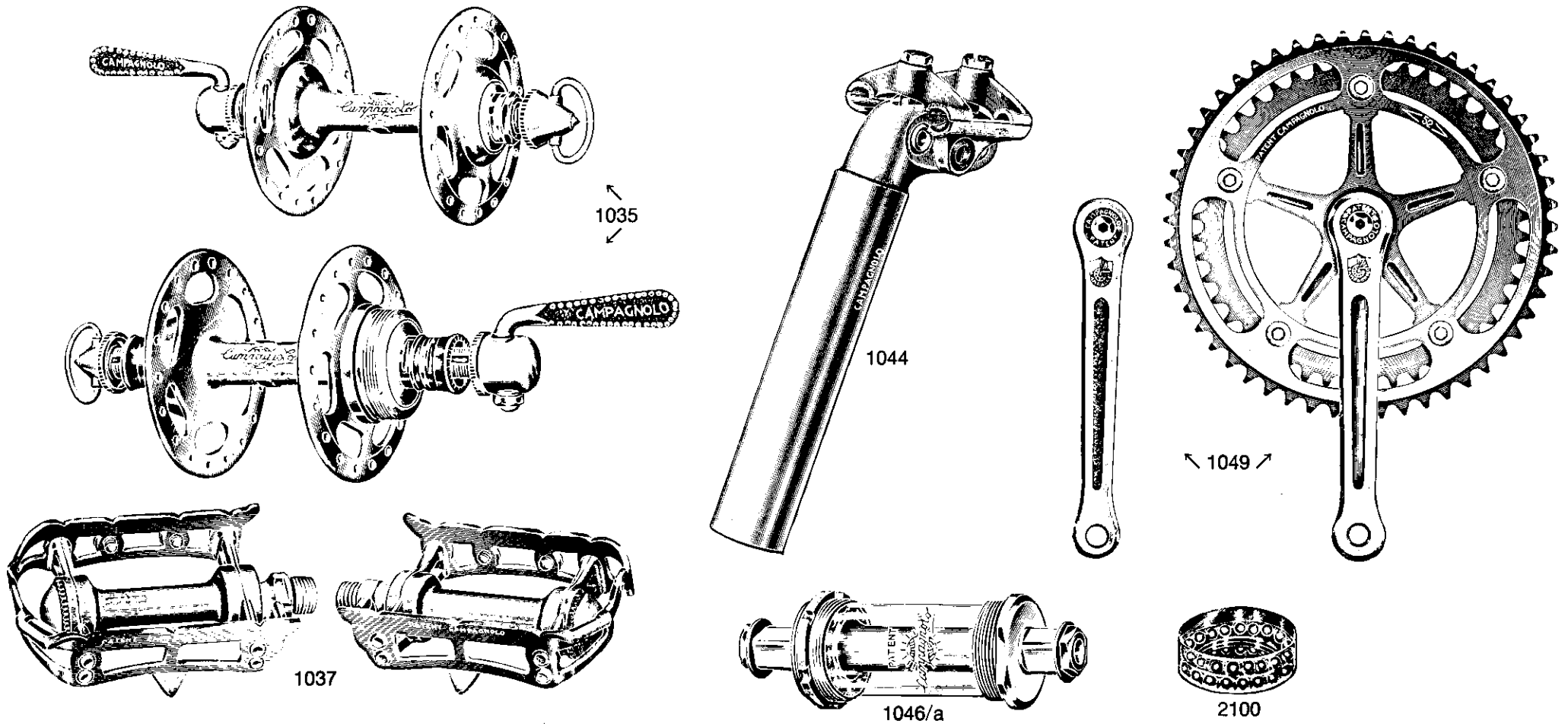

- 606 Down tube gear cable (118 cm)
- 608 Down tube front changer cable (70 cm)
- 622 Rear stainless steel outer cable (21 cm)
- 626/a Twin gear cables clip
- 632 Seat tube pump clip
- 636 Top tube pump clip

- 649 Brake cable clips
- 1010 Record fork ends set
- 1014 Twin down tube control levers
- 1020/a Nuovo Record gear (without hanger)
- 1030/2 Special pump adaptor (thread  $\varnothing 9 \times 1,25$  - Any of the pump adaptors shown on page 34 can be supplied instead)

# ROAD ENSEMBLE

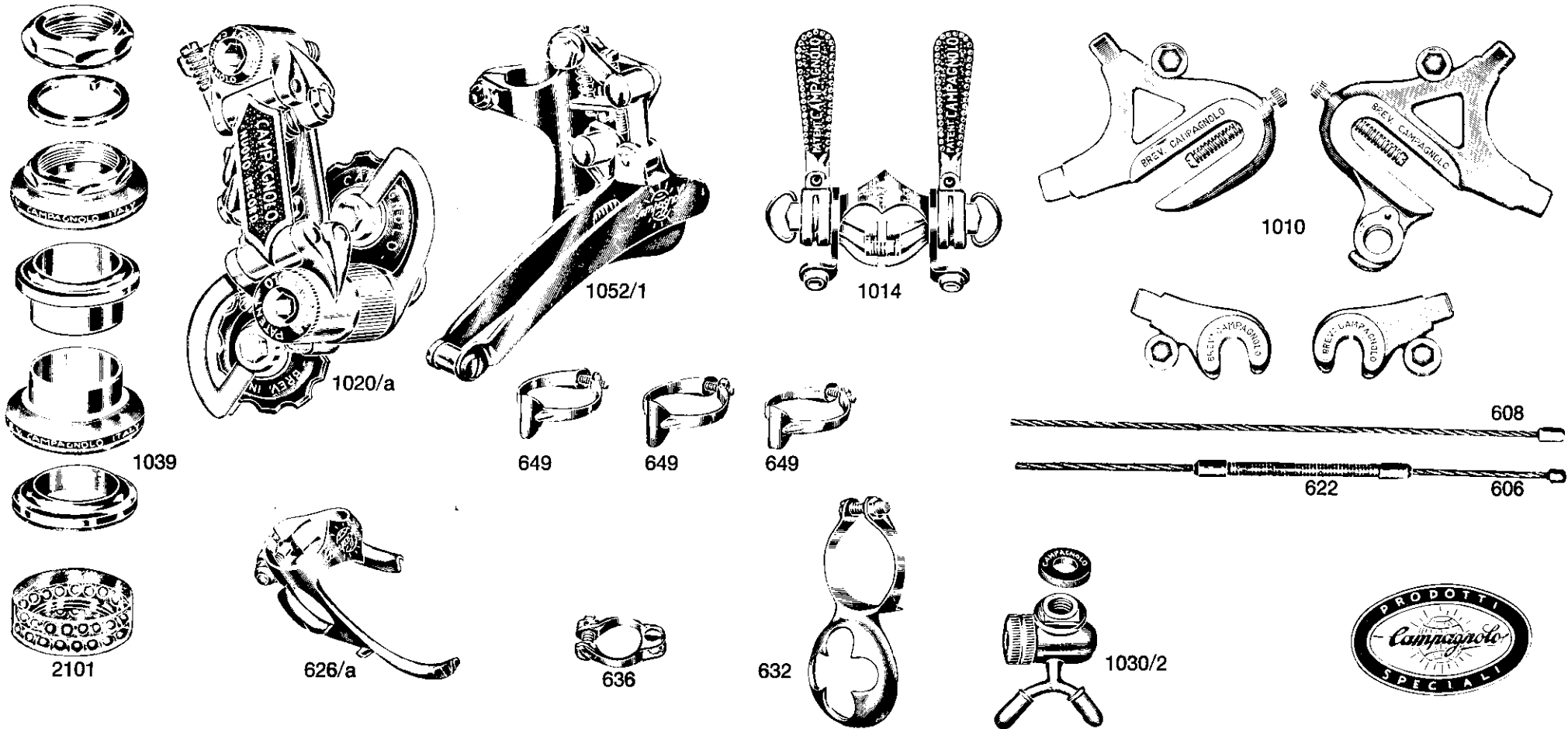

- 1035 **Pair of Record large flange quick release hubs** (front width 100 mm. - rear width 120 mm.)
- 1037 **Pair of Record road pedals** (spindle thread  $\varnothing$  9/16"  $\times$  20F.)
- 1039 **Record road head set** (thread 25,4  $\times$  24F.)
- 1044 **Seat pin for saddles with normal springs** (please specify diameter and length as shown on page 30. If requested seat pin 1045 for wide spring saddles can be supplied)

- 1046/a **Nuovo Record bottom bracket set** (for 70 mm. bottom bracket and with 118 mm. spindle - see page 25)
- 1049 **Road chainwheel set** (please specify number of chainering teeth and cranks length - see page 20)
- 1052/1 **Record front changer**
- 2100 **Special ballraces for bottom bracket set**
- 2101 **Special ballraces for head set**

# 1033 - CAMPAGNOLO RECORD

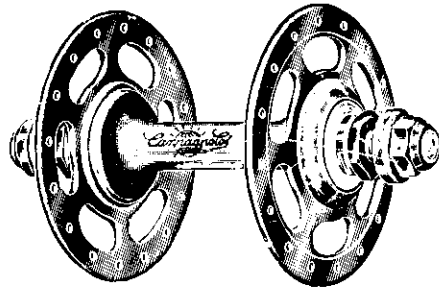

1036

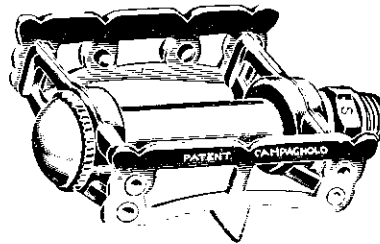

1038

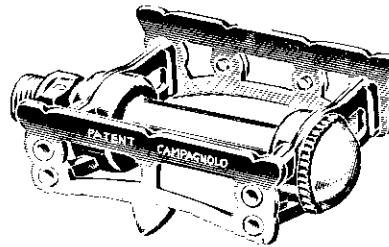
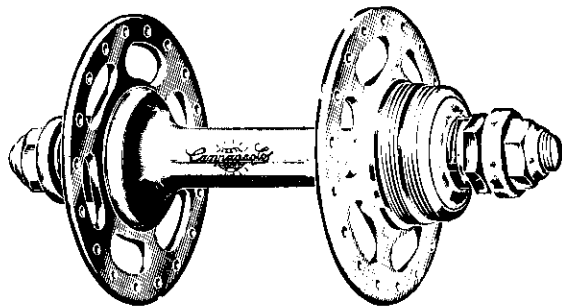

↙ 1051 ↘

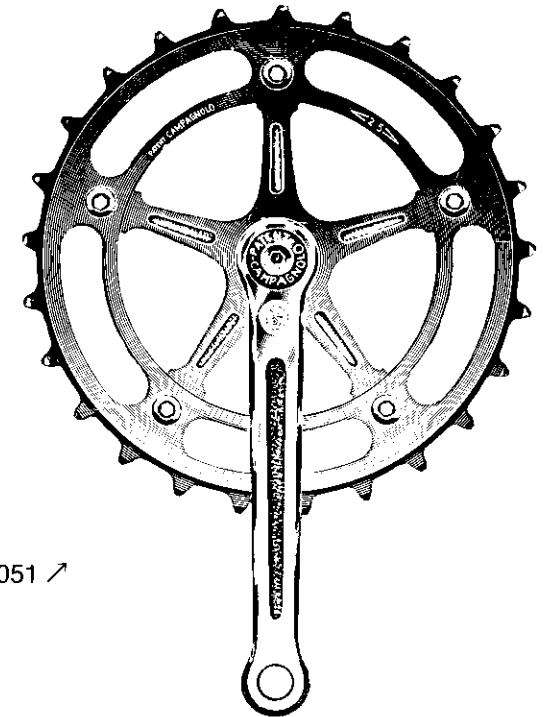

- 1036 **Pair** of Record track hubs (front width 100 mm. - Rear width 110 mm.)
- 1038 **Pair** of Record track pedals (spindle thread : 9/16" x 20 F.)
- 1040 **Record** track head set (thread : 25.4 x 24 F.)



# TRACK ENSEMBLE

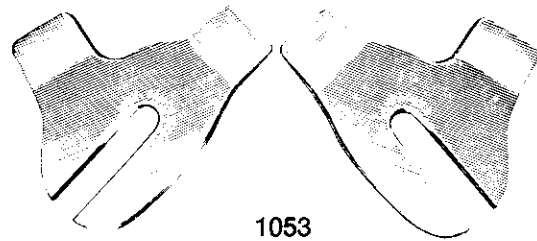
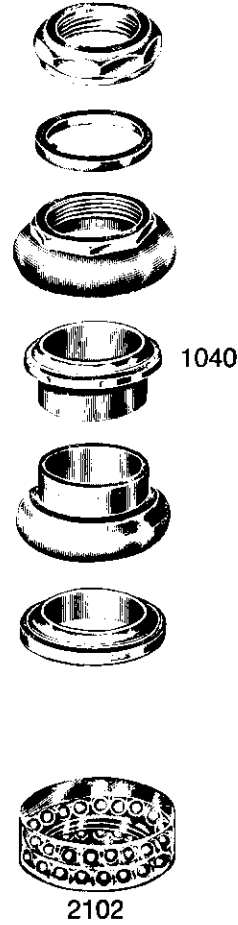
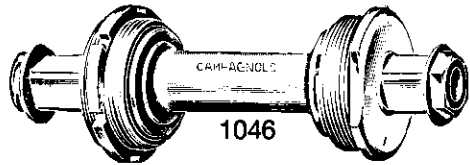

- 1044 **Seat** pin for saddles with normal springs (please specify diameter and length as shown on page 30 - If requested seat pin 1045 for wide spring saddles can be supplied)
- 1046 **Record** bottom bracket set (for 65 mm. bracket and with 104 mm. spindle - see page 24)
- 1053 **Track** fork ends set

- 1051 **Track** chainwheel set (chainring for chain 1" x 3/16" - Available also for chains 1" x 1/8" or 1/2" x 1/8"). - Please specify number of chainring teeth and cranks length - see page 21)
- 2100 **Special** ballraces for bottom bracket set
- 2102 **Special** ballraces for head set

# CAMPAGNOLO NUOVO RECORD GEAR RECORD FRONT CHANGER

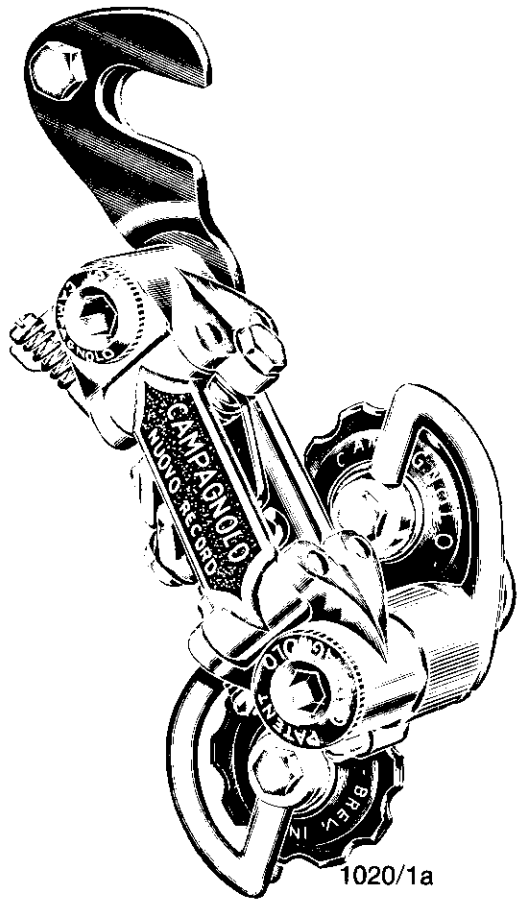

TWIN DOWN TUBE CONTROL  
LEVERS WITH BARE CABLES

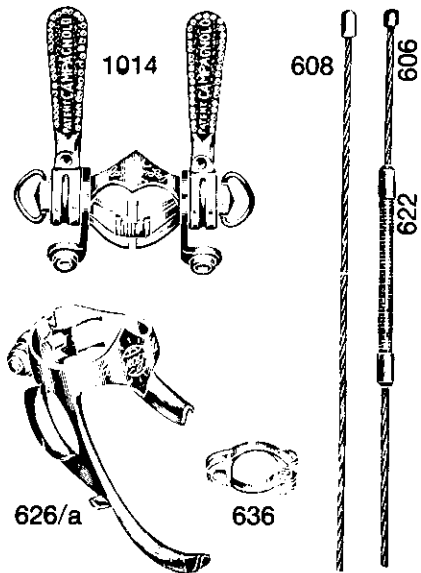

TWIN HANDLEBAR CONTROL  
LEVERS WITH BARE CABLES

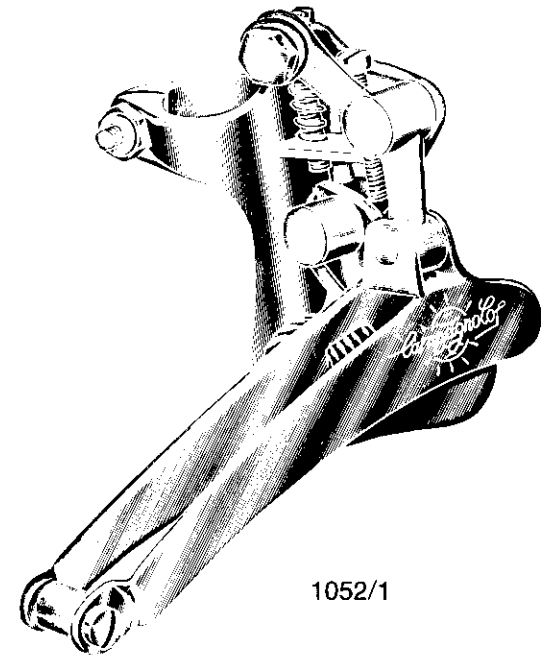
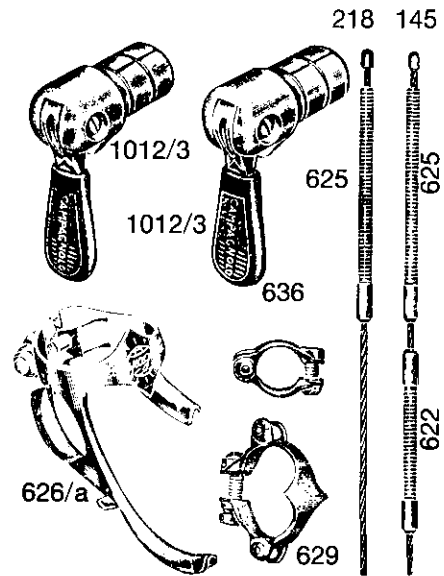

- 145 **Handlebar** control gear cable
- 218 **Handlebar** control front changer cable
- 606 **Down tube** control gear cable (118 cm.)
- 608 **Down tube** control front changer cable (70 cm.)

- 622 **Rear** handlebar control outer cable (21 cm.)
- 625 **Front** handlebar control outer cable (75 cm.)
- 626/a **Twin** control cable guide
- 629 **Twin** handlebar control clip
- 636 **Chainstay** clip

- 1012/3 **Handlebar** control
- 1014 **Twin** control lever
- 1020/1a **Nuovo Record** gear with hanger
- 1052/1 **Record** front changer

## RECORD FRONT CHANGER SPARE PARTS

- 773 Record front changer body
- 774 Adjusting bolt
- 775 Adjusting bolt spring
- 776 Clip fixing screw
- 777 Clip nut
- 778 Upper arm
- 779 Cable clamp bolt
- 780 Washer for bolt 779
- 782 Lower arm
- 784 Front changer cage
- 785 Ferrule for front changer cage
- 786 Spindle for front changer cage
- 787 Front changer return spring
- 788 Cage shank bolt
- 789 Cage nut
- 790 Roller
- 791 Cable bolt

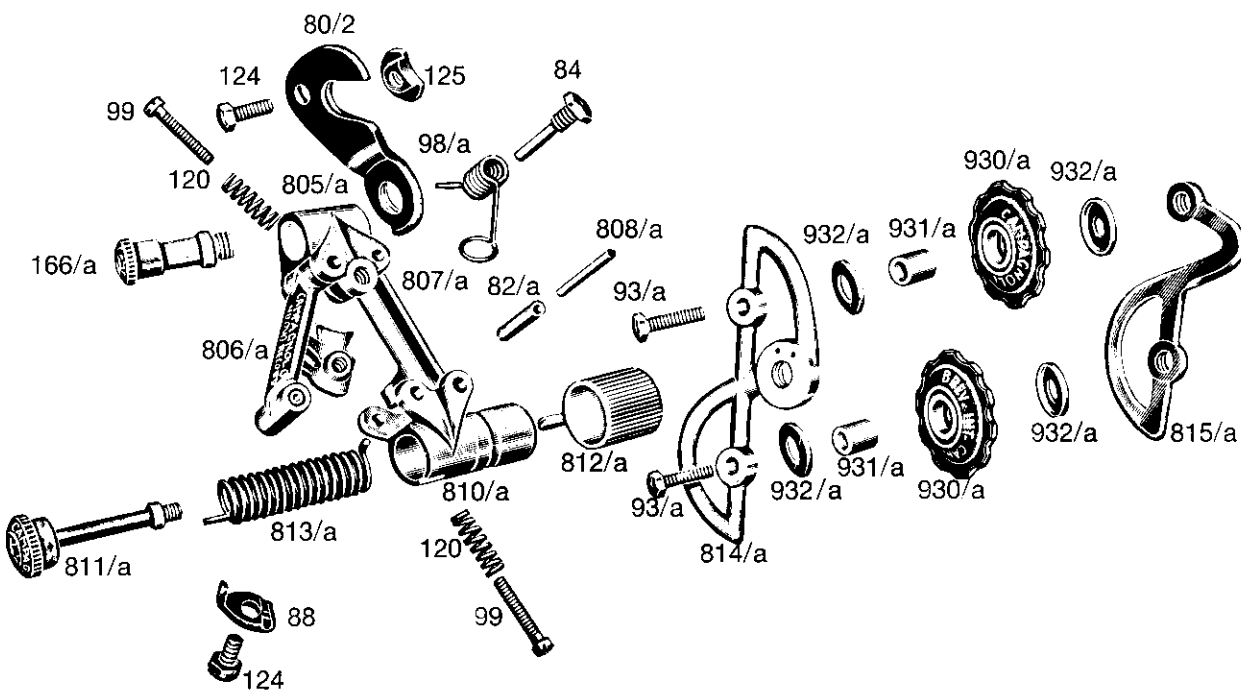
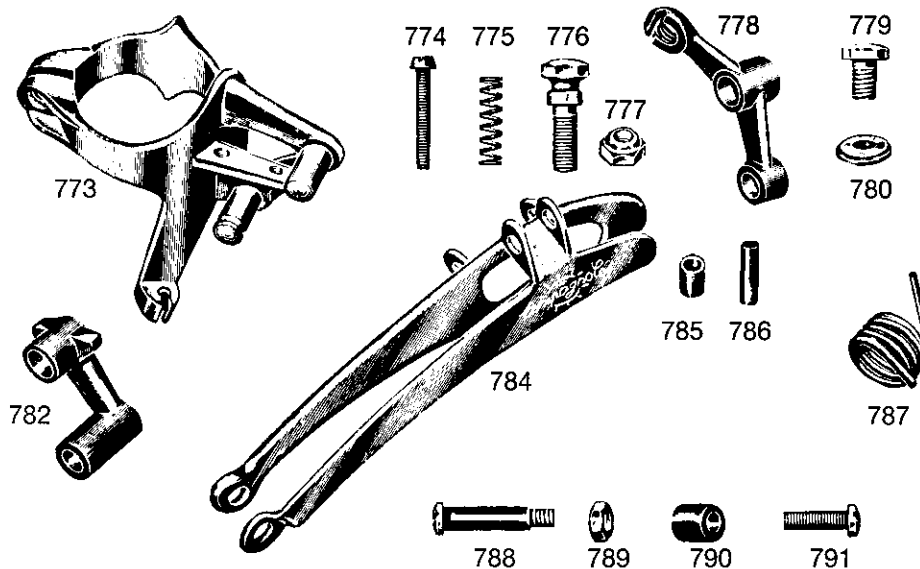

## NUOVO RECORD GEAR SPARE PARTS

- |       |                      |       |                   |
|-------|----------------------|-------|-------------------|
| 80/2  | Gear fixing plate    | 806/a | Front arm         |
| 82/a  | Body ferrule         | 807/a | Inner arm         |
| 84    | Spring screw         | 808/a | Spindle           |
| 88    | Clamp wascher        | 810/a | Spring cage       |
| 93    | Sprocket bolt        | 811/a | Gear spring bolt  |
| 98/a  | Gear return spring   | 812/a | Spring cage cover |
| 99    | Gear adjusting screw | 813/a | Tension spring    |
| 120   | Safety spring        | 814/a | Outer cage plate  |
| 124   | Fixing screw         | 815/a | Inner cage plate  |
| 125   | Clamp nut            | 930/a | Roller            |
| 166/a | Uppur pivot bolt     | 931/a | Roller bush       |
| 805/a | Rear body            | 932/a | Roller dust cover |

# CAMPAGNOLO VALENTINO EXTRA GEAR VALENTINO FRONT CHANGER

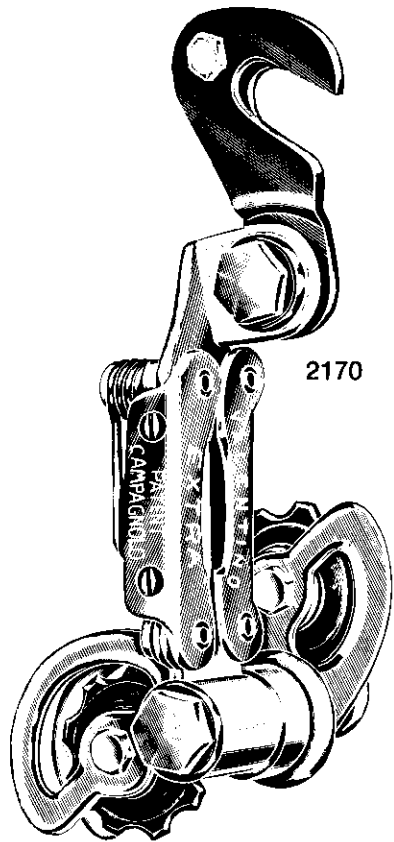

RIGHT HAND DOWN TUBE CONTROL WITH COVERED CABLES    TWIN CONTROL LEVER ONLY WITH CABLES

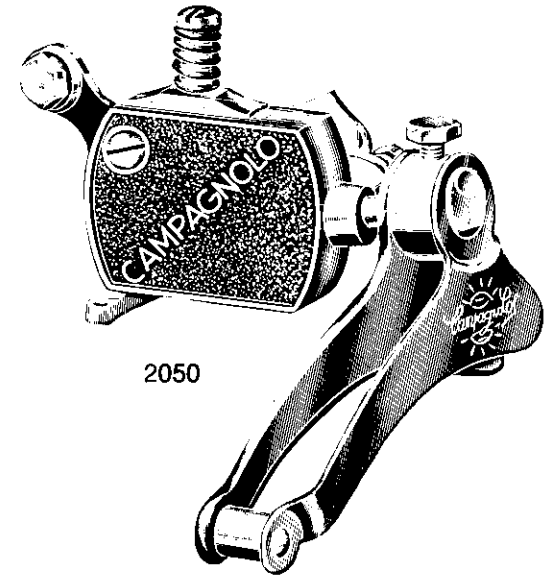
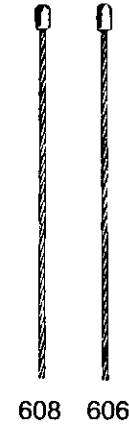
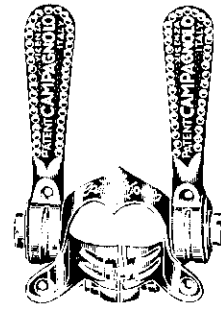
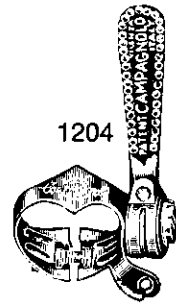

605 Gear outer casing (105 cm.)

606 Gear cable to frame control (118 cm.)

608 Front changer cable to frame control (70 cm.)

1204 Valentino right hand down tube control lever

1206 Valentino twin control lever

2050 Valentino front changer

2170 Valentino Extra gear complete with hanger

## VALENTINO FRONT CHANGER SPARE PARTS

- 89 Bolt for lip plate
- 210 Body clip bolt
- 211 Body fixing clip
- 213 Fork fixing bolt
- 214 Fork-cage
- 217 Nut for spacing screw bolt
- 226 Adjusting bolt spring
- 227 Adjusting lever screw
- 780 Cable clamp screw washer
- 1601 Front changer body
- 1602 Control fork
- 1603 Spindle
- 1604 Return spring
- 1605 Bolt

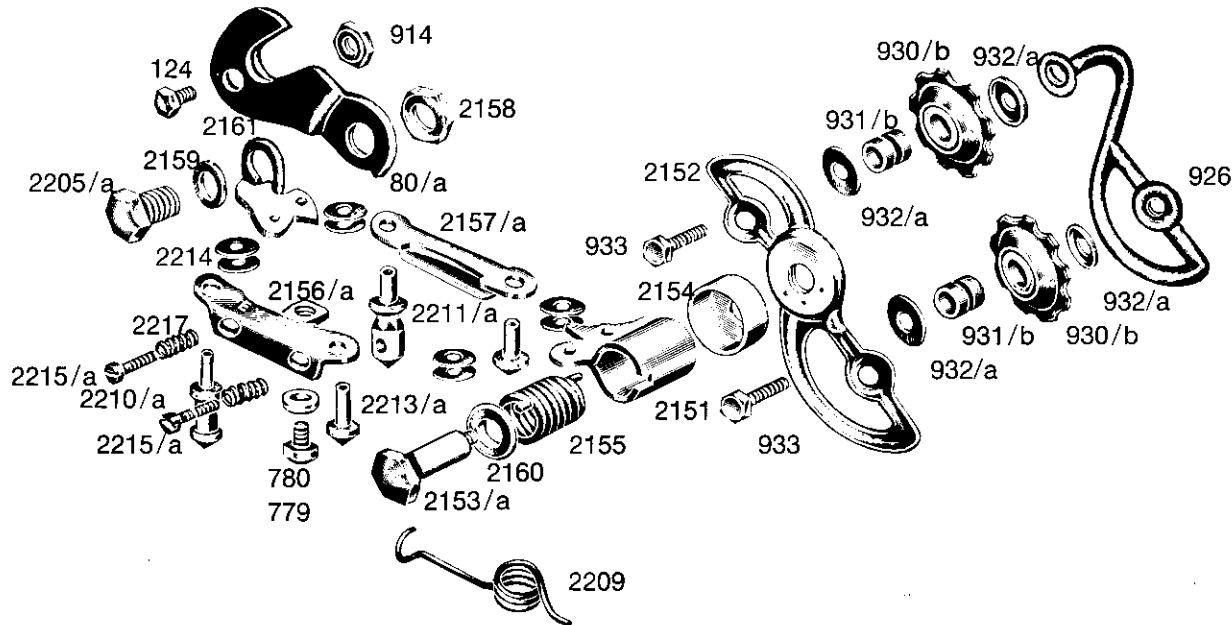
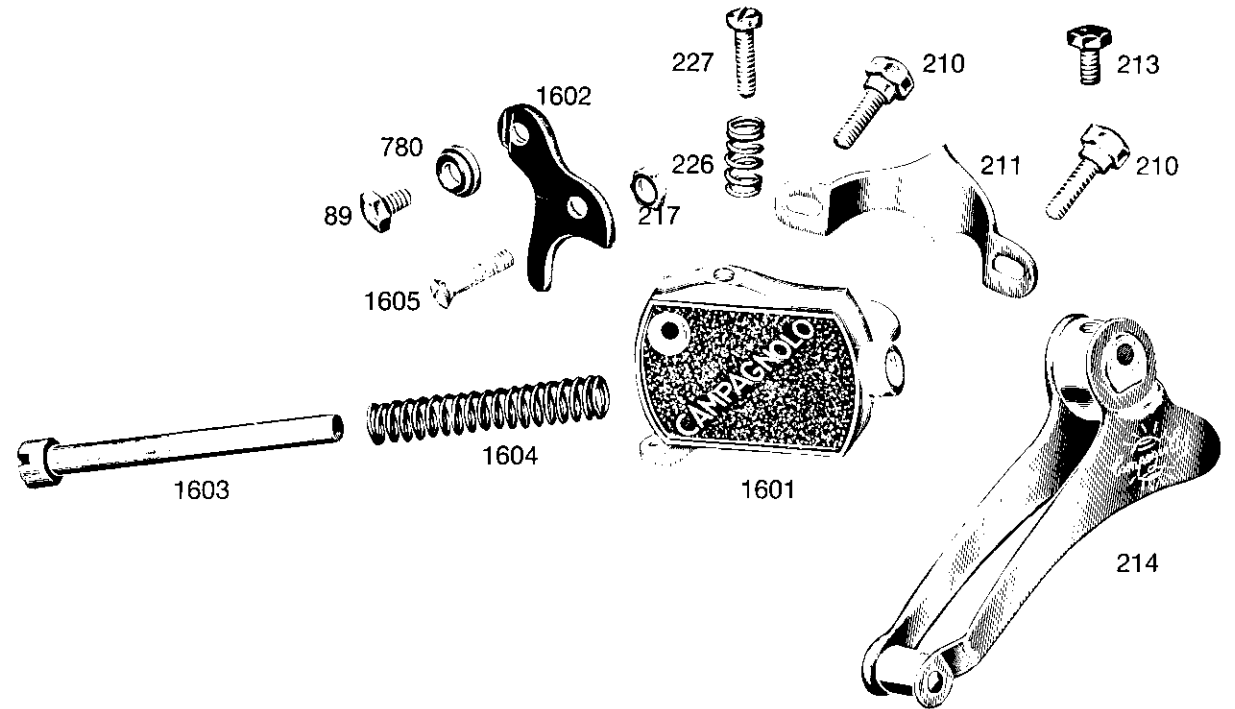

## VALENTINO EXTRA GEAR SPARE PARTS

- |        |                           |        |                         |
|--------|---------------------------|--------|-------------------------|
| 80/a   | Gear fixing plate         | 2156/a | Outer arm               |
| 124    | Fixing screw              | 2157/a | Inner arm               |
| 779    | Cable clamp screw         | 2158   | Gear counter fixing nut |
| 780    | Cable clamp screw washer  | 2159   | Gear hanger bolt        |
| 914    | Nut for fixing plate bolt | 2160   | Spring cage cover       |
| 926    | Inner cage plate          | 2161   | Rear body               |
| 930/b  | Rollers                   | 2205/a | Fixing pivot bolt       |
| 931/b  | Roller bushes             | 2209   | Gear return spring      |
| 932/a  | Roller dust cover         | 2210/a | Return spring spindle   |
| 933    | Roller bolt               | 2211/a | Spindle                 |
| 2151   | Spring cage               | 2213/a | Arm rivets              |
| 2152   | Outer cage plate          | 2214   | Spring washer           |
| 2153/a | Spring cage bolt          | 2215/a | Adjusting bolt          |
| 2154   | Cover                     | 2217   | Adjusting screw spring  |
| 2155   | Gear tension spring       |        |                         |

# CAMPAGNOLO SPORT EXTRA GEAR

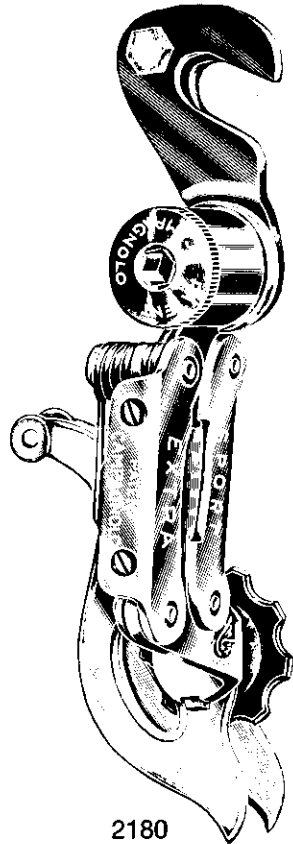

2180

- 605 Gear outer casing (105 cm.)
- 606 Gear cable to frame control (118 cm.)
- 1204 Valentino right hand down tube control lever
- 2180 Sport Extra gear complete with hanger

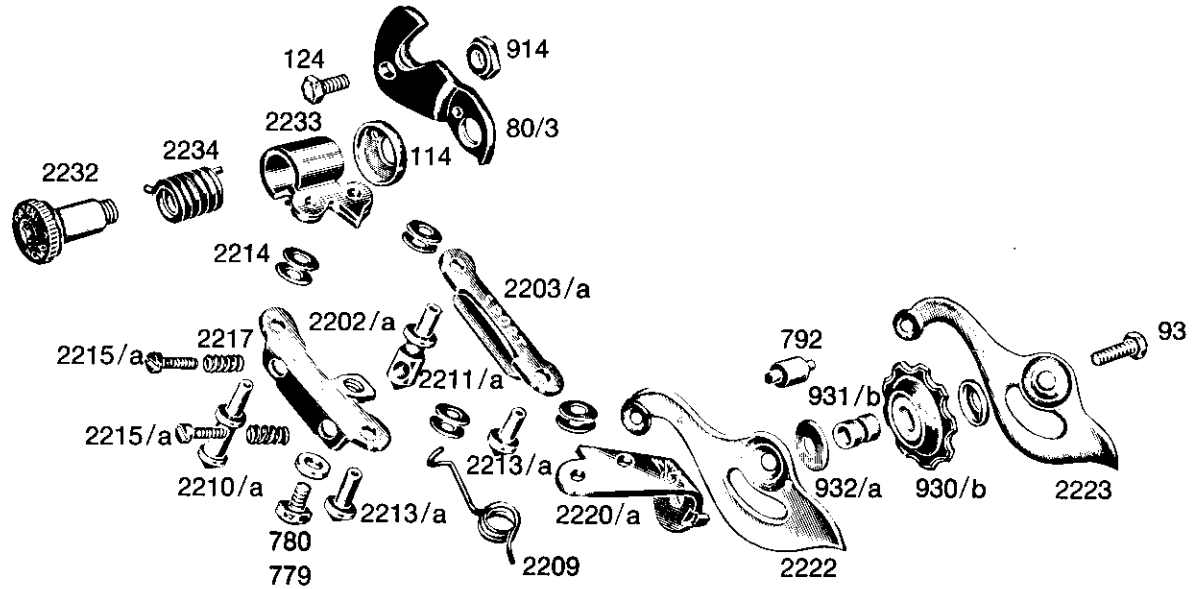

## VALENTINO RIGHT HAND CONTROL

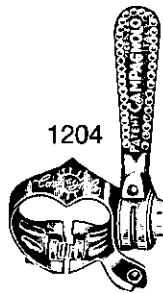

1204



606

605

## SPORT EXTRA GEAR SPARE PARTS

- |        |                          |        |                        |
|--------|--------------------------|--------|------------------------|
| 80/3   | Gear fixing plate        | 2209   | Gear return spring     |
| 93     | Roller axle bolt         | 2210/a | Return spring spindle  |
| 114    | Spring retaining cap     | 2211/a | Spindle                |
| 124    | Fixing screw             | 2213/a | Arm rivets             |
| 779    | Cable clamp screw        | 2214   | Spring washer          |
| 780    | Cable clamp screw washer | 2215/a | Adjusting bolt         |
| 792    | Cage plates connector    | 2217   | Adjusting screw spring |
| 914    | Fixing plate nut         | 2220/a | Roller cage            |
| 930/b  | Roller                   | 2222   | Outer cage plate       |
| 931/b  | Roller bush              | 2223   | Inner cage plate       |
| 932/a  | Roller dust cap          | 2232   | Spring cage bolt       |
| 2202/a | Outer arm                | 2233   | Spring cage            |
| 2203/a | Inner arm                | 2234   | Gear tension spring    |

# CAMPAGNOLO VALENTINO CONTROLS

RIGHT HAND DOWN TUBE CONTROL WITH COVERED CABLES

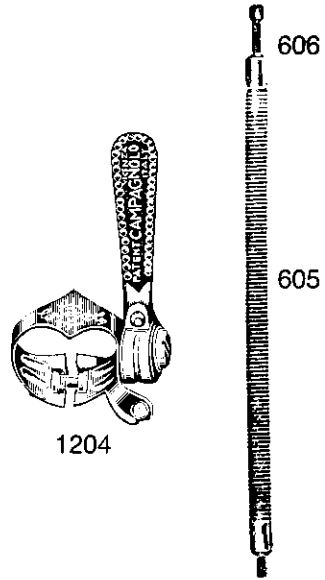

VALENTINO CONTROL SPARE PARTS

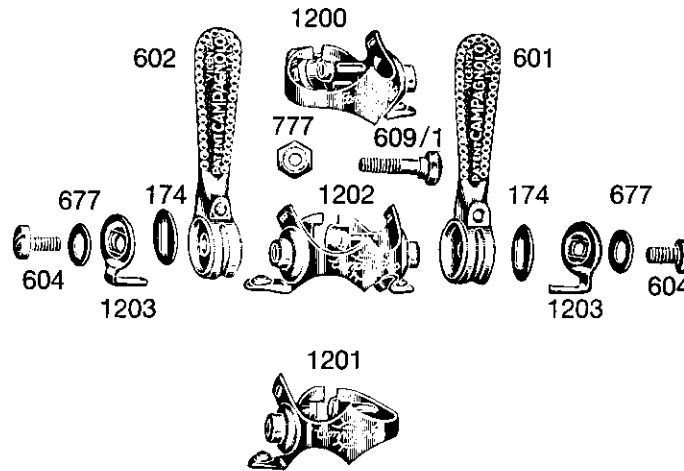

TWIN CONTROL LEVER ONLY WITH CABLES

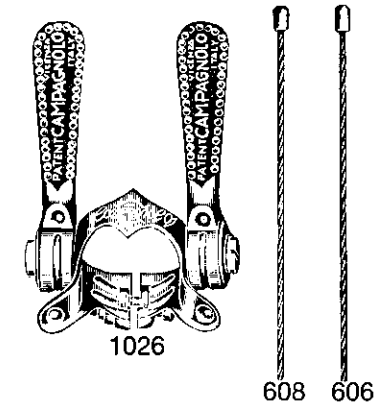

- 174 Friction plate
- 601 Right hand control lever only
- 602 Left hand control lever only
- 604 Friction adjusting screw
- 605 Gear outer casing (105 cm.)

- 606 Gear cable to frame control (118 cm.)
- 608 Front changer cable to frame control (70 cm.)
- 609 Clip bolt and nut
- 677 Washer
- 777 Clip fixing bolt nut
- 1200 Right hand pressed collar

- 1201 Down tube front changer control clip
- 1202 Down tube twin control clip
- 1203 Cover
- 1204 Valentino right hand down tube control lever
- 1206 Valentino twin control lever

# CAMPAGNOLO RECORD CONTROL SYSTEMS

## TWIN CONTROL LEVER WITH COVERED CABLES

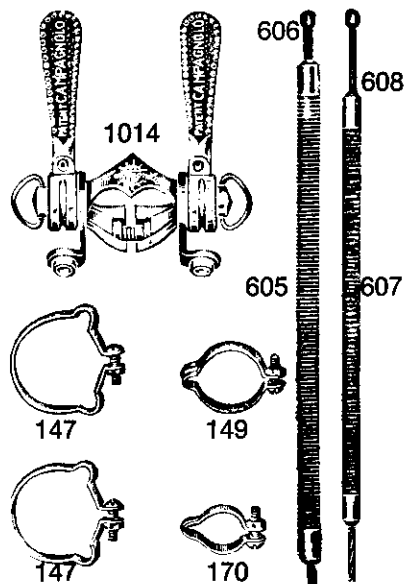

## BRAZE-ON CONTROL SYSTEMS AND BARE CABLES

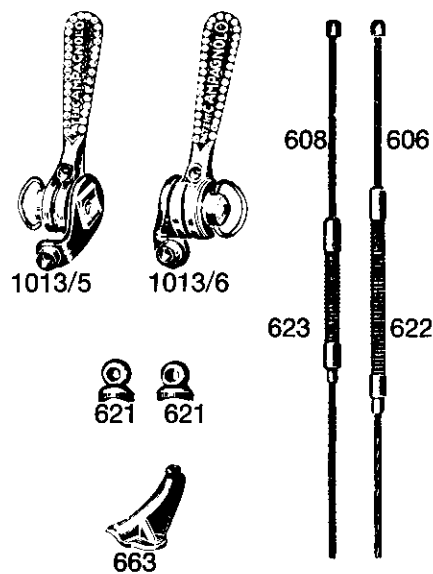

## TWIN CONTROL SYSTEM WITH PUMP HOLDER AND BARE CABLES

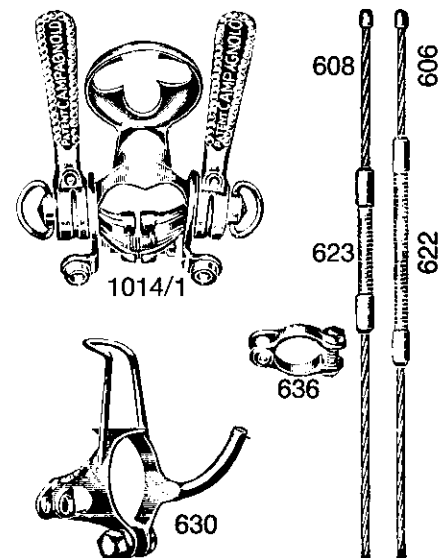

602

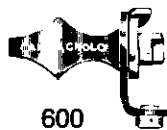

600



601



603



604



604/1



609



612



174

- 137 Segment expanding screw
- 138 Segment
- 139/1 Counter-nut
- 139/2 Hexagonal screw
- 140/1 Tension adjusting screw
- 142 Spring segment holder
- 145 Rear derailleur cable to handlebar control (197 cm.)
- 147 Outer casing clip

- 149 Outer cable clip
- 170 Outer cable clip
- 173 Rubber covers for shifters
- 174 Friction plate
- 174/1 Friction plate
- 200/2 Handlebar control body
- 201 Handlebar lever
- 218 Handlebar control front changer cable (150 cm.)

- 600 Right hand lever collar
- 600/2 Control lever plate
- 601 Right hand control lever only
- 602 Left hand control lever only
- 603 Cover plate
- 604 Friction adjusting screw
- 604/1 Friction adjusting wing nut (as alternative to 604)
- 605 Gear outer casing (105 cm.)



# CAMPAGNOLO RECORD CONTROL SYSTEMS

## HANDLEBAR CONTROL WITH BARE CABLES

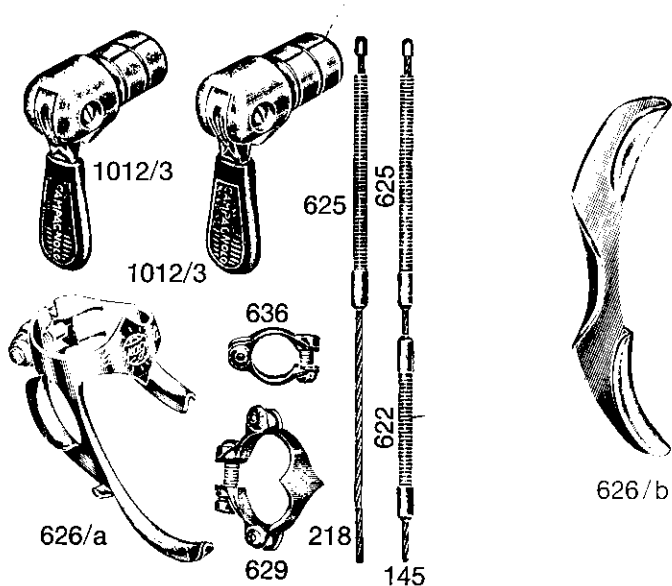

## DOWN TUBE CONTROL WITH BARE CABLE

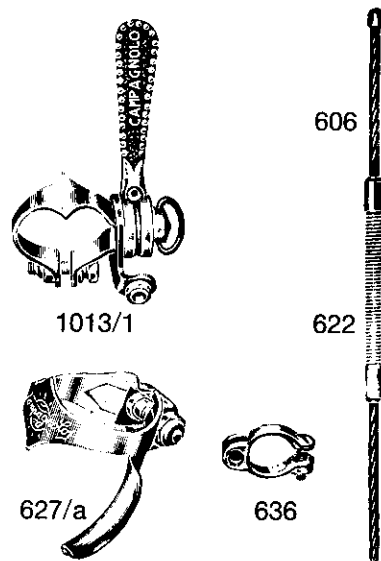

## BRAZE-ON CONTROL WITH BARE CABLE

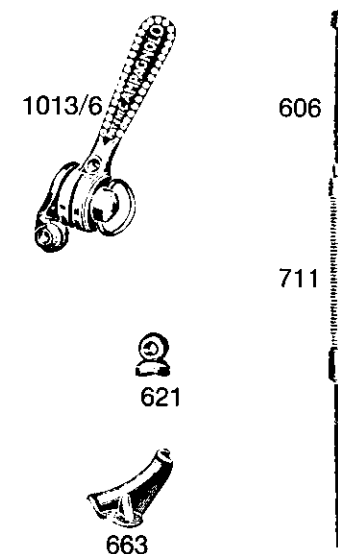

- 606 Gear cable to frame control (118 cm.)
- 607 Down tube front outer casing (59 cm.)
- 608 Front changer cable to frame control (70 cm.)
- 609 Clip bolt and nut
- 612 Cable stop
- 621 Braze-on cable stop
- 622 Rear derailleur steel outer casing
- 623 Front changer steel outer casing

- 625 Steel outer casing to down tube handlebar control (75 cm.)
- 626/a Double stop clips for down tube controls
- 626/b Braze-on cable ferrule
- 627/a Down tube tunnel R/H for gear
- 629 Double stop cable clip for handlebar control
- 630 Pump holder, No. 630
- 636 Stop clip on chainstay for rear derailleur
- 660 Braze-on boss

- 661 Brazed boss collar
- 663 Braze-on cable ferrule
- 711 Gear vipla cable (23 cm.)
- 1012/3 Handlebar controls
- 1013/1 Right hand down tube control
- 1013/6 Gear braze-on control
- 1014 Twin down tube control lever
- 1014/1 Twin down tube control lever with pump clip

1034 **RECORD SMALL FLANGE CAMPAGNOLO**  
QUICK RELEASE ROAD HUBS

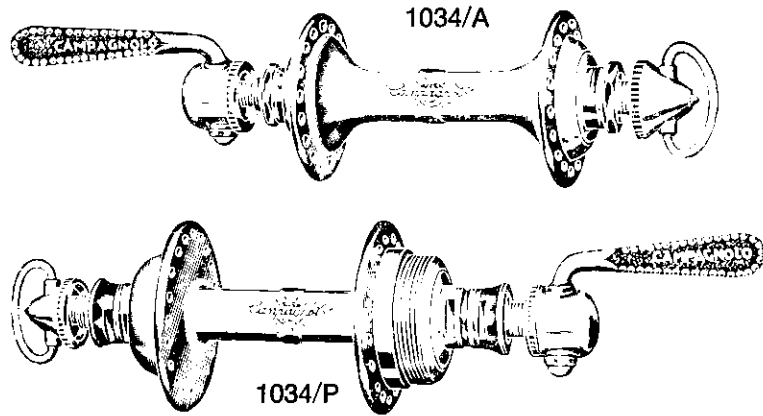

1035 **RECORD LARGE FLANGE CAMPAGNOLO**  
QUICK RELEASE ROAD HUBS

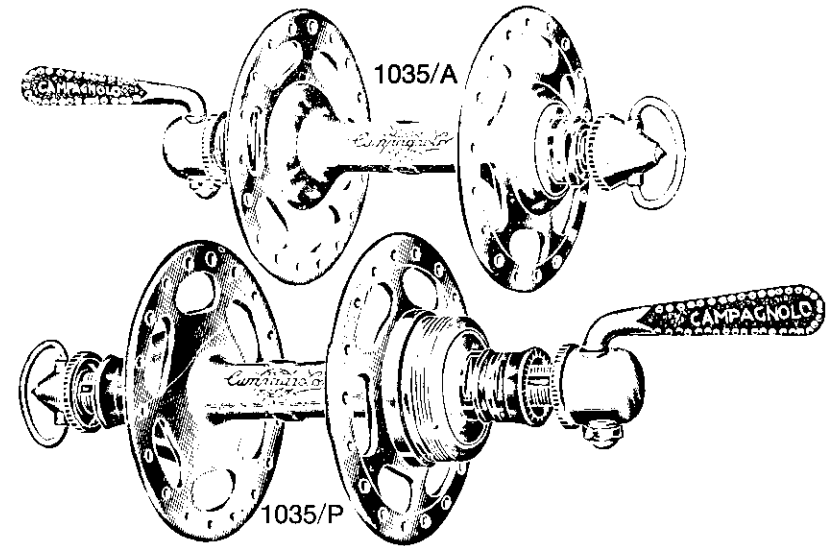

1036 **RECORD LARGE FLANGE SOLID SPINDLE**  
TRACK HUBS

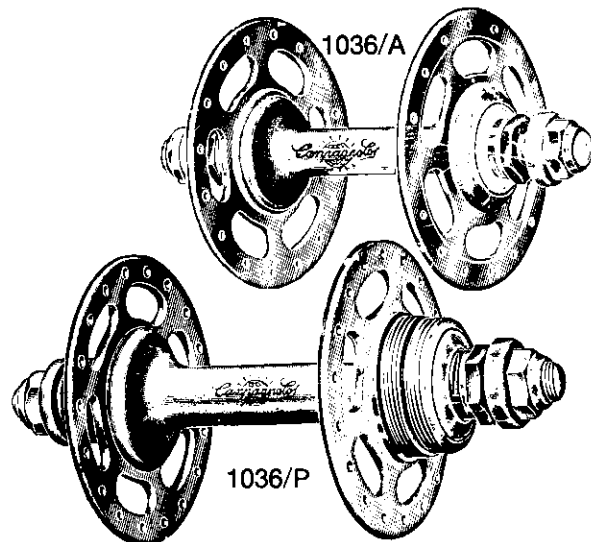

1036/2 **RECORD SMALL FLANGE SOLID SPINDLE**  
TRACK HUBS

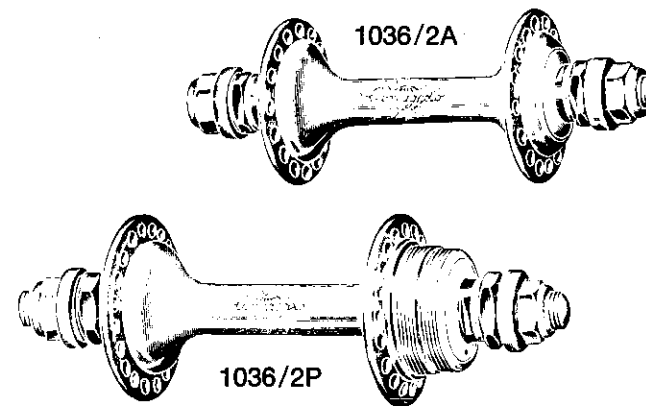

WHEN ORDERING PLEASE SPECIFY: } THERAD (Ø 35 × 24 F. OR Ø 34,7 × 1 OR Ø 1.370 × 24 F.)  
} NUMBER OF HOLES (24 - 28 - 32 - 36 - 40)

HUBS ORDERED WITHOUT SPECIFICATION WILL BE SUPPLIED  
WITH Ø 35 × 24 F. AND WITH 36 HOLES

SIX-SPROCKETS HUBS ALSO AVAILABLE

# CAMPAGNOLO RECORD HUBS AND QUICK RELEASE SPARE PARTS

FRONT

REAR

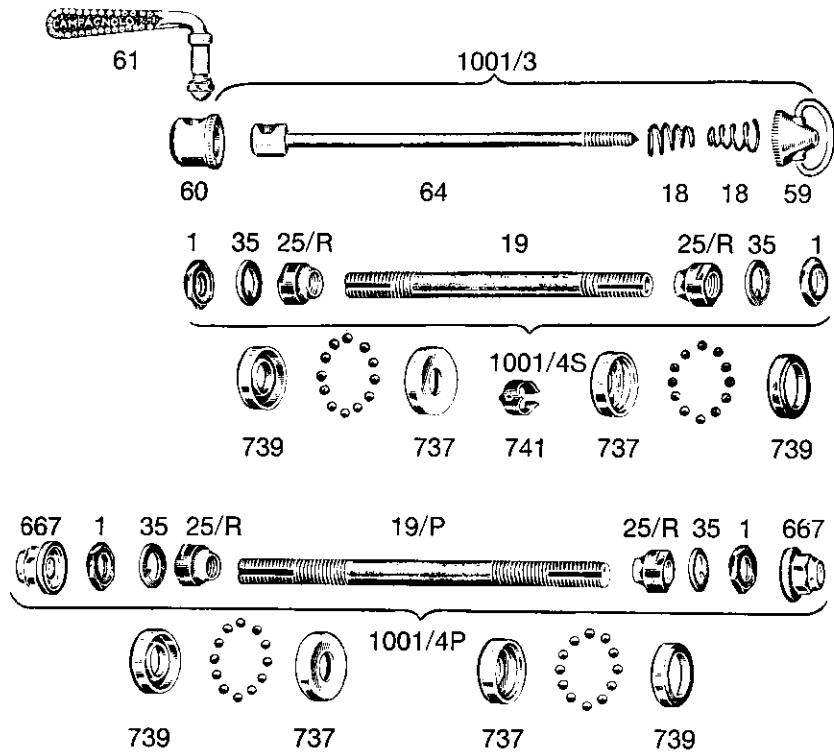

QUICK RELEASE

RECORD ROAD

RECORD TRACK

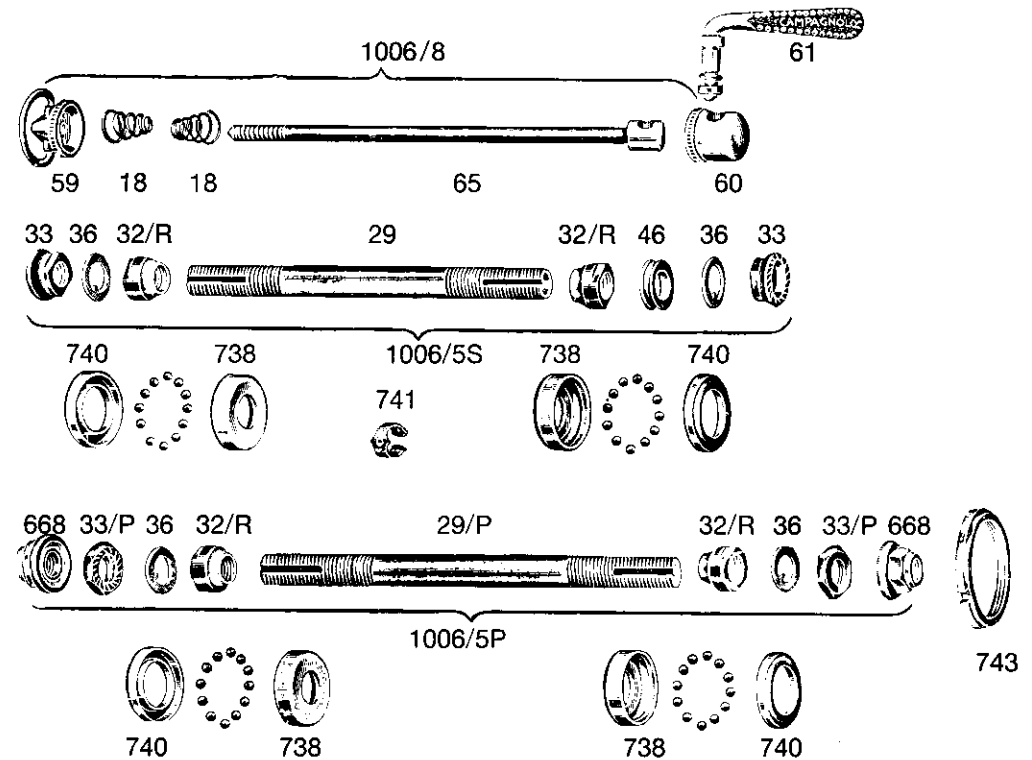

- 1 Front lock nut
- 18 Conical spring
- 19 Front road axle for Record road hubs
- 19/P Front track solid spindle axle
- 25/R Record front cone
- 29 Rear road axle for Record road hubs
- 29/P Rear track solid spindle
- 32/R Record rear cone
- 33 Rear lock nut for Record road hubs
- 33/P Rear lock nut for Record track hubs
- 35 Front spindle washer

- 36 Rear spindle washer
- 46 Rear spacing collar
- 59 Quick release conical adjuster
- 60 Quick release lever housing
- 61 Complete quick release lever
- 64 Quick release front skewer
- 65 Quick release rear skewer
- 667 Track front nut
- 668 Track rear nut
- 737 Front Record ball cup
- 738 Rear Record ball cup

- 739 Front dust cover
- 740 Rear dust cover
- 741 Spring clip
- 743 Track lock ring
- 1001/3 Front quick release skewer complete
- 1001/4P Front track axle complete
- 1001/4S Front road axle complete
- 1006/5P Rear track axle complete
- 1006/5S Rear road axle complete
- 1006/8 Rear quick release skewer complete

1251 **NUOVO TIPO SMALL FLANGE CAMPAGNOLO**  
**QUICK RELEASE HUBS**

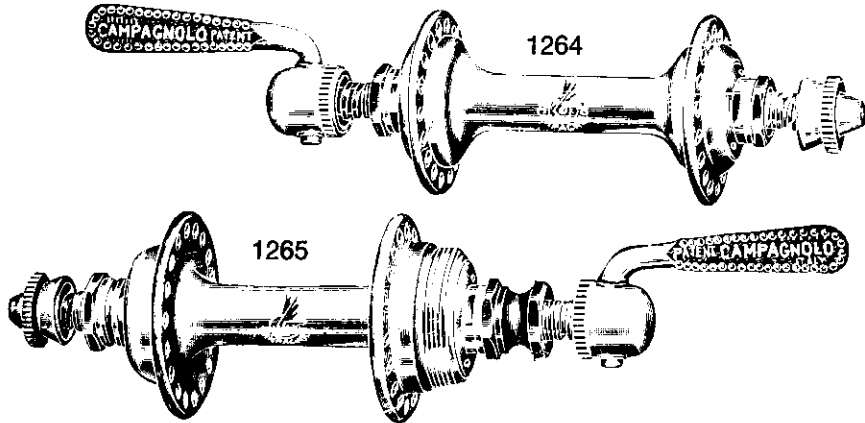

1250 **NUOVO TIPO SMALL FLANGE CAMPAGNOLO**  
**SOLID SPINDLE HUBS**

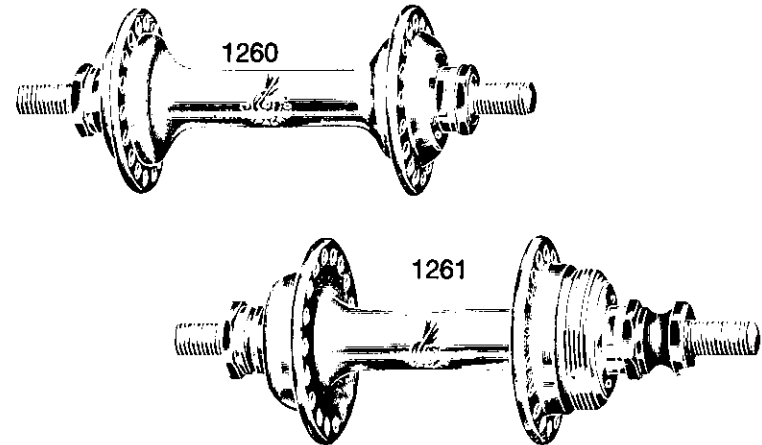

1253 **NUOVO TIPO LARGE FLANGE CAMPAGNOLO**  
**QUICK RELEASE HUBS**

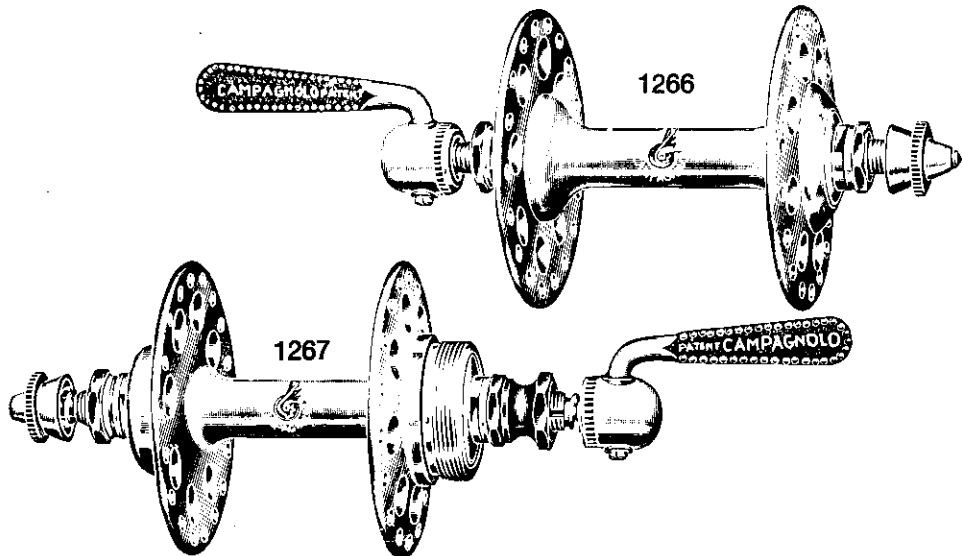

1252 **NUOVO TIPO LARGE FLANGE CAMPAGNOLO**  
**SOLID SPINDLE HUBS**

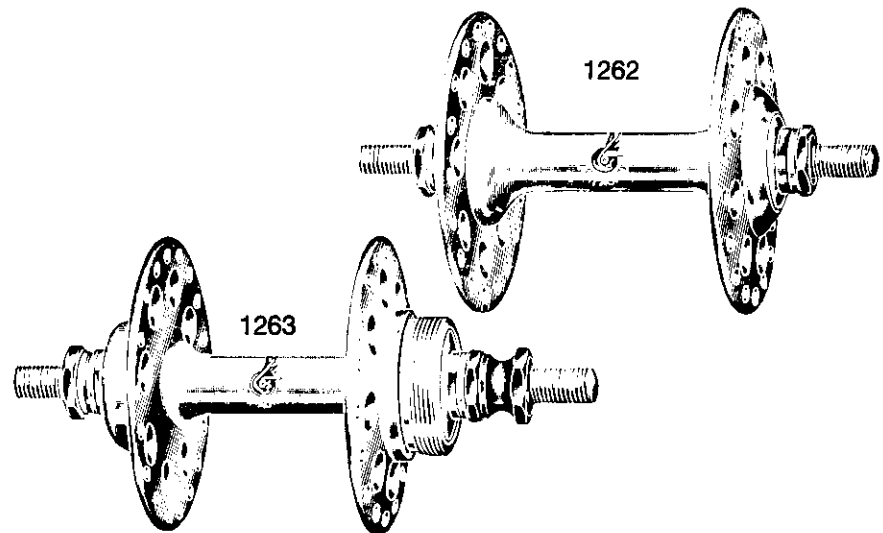

WHEN ORDERING PLEASE SPECIFY: } THREAD (Ø 35 × 24 F. OR Ø 34,7 × 1 OR Ø 1.370 × 24 F.)  
 } NUMBER OF HOLES (24 - 28 - 32 - 36 - 40)

HUBS ORDERED WITHOUT SPECIFICATION WILL BE SUPPLIED  
 WITH Ø 35 × 24 F. AND WITH 36 HOLES

# CAMPAGNOLO NUOVO TIPO AND QUICK RELEASE SPARE PARTS

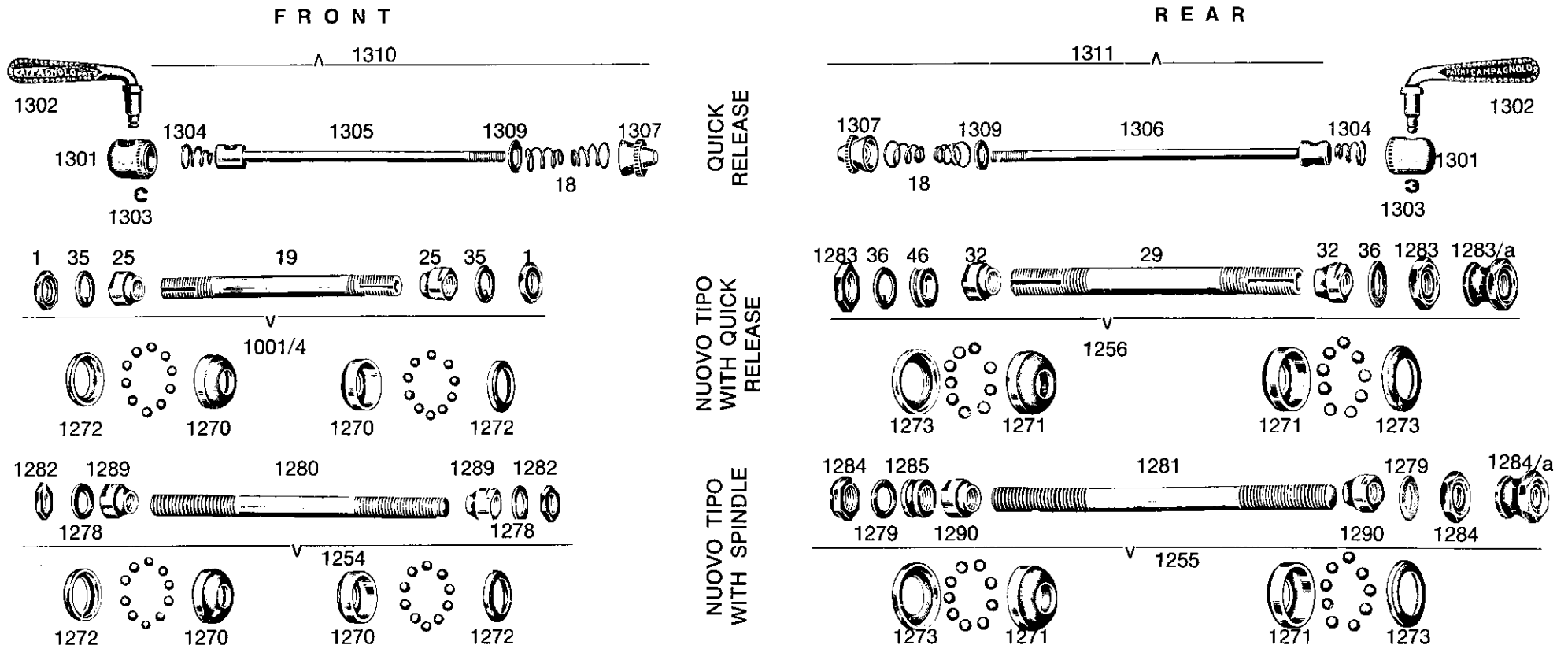

- 1 Front lock nut
- 18 Conical spring
- 19 Front road axle for Record road hubs
- 25 Front Record cone
- 29 Rear road axle
- 32 Rear Record cone
- 35 Front spindle washer
- 36 Rear spindle washer
- 46 Rear spacing collar
- 1001/4 Complete front hollow spindle for Nuovo Tipo hubs
- 1254 Complete rear solid spindle for Nuovo Tipo hubs
- 1255 Complete rear solid spindle for Nuovo Tipo hubs
- 1256 Complete rear hollow spindle for Nuovo Tipo hubs

- 1270 Front inserted race
- 1271 Rear inserted race
- 1272 Front dust cap
- 1273 Rear dust cap
- 1278 Spindle front washer
- 1279 Spindle rear washer
- 1280 Front spindle
- 1281 Rear spindle
- 1282 Front locknut
- 1283 Rear locknut
- 1283/a Rear spacer nut
- 1284 Rear locknuts
- 1284/a Spindle special bolt

- 1285 Large spacing collar
- 1286 Small spacing collar
- 1289 Front spindle cone
- 1290 Rear spindle cone
- 1301 Chrome cam cap
- 1302 Quick release lever
- 1303 Circlip for lever
- 1304 Conical spring
- 1305 Front skewer
- 1306 Rear skewer
- 1307 Knurled adjusting nut
- 1309 Washer for skewer
- 1310 Nuovo Tipo front quick release skewer
- 1311 Nuovo Tipo rear quick release skewer

# 1048 - RECORD CHAINWHEEL SET - ROAD BOTTOM BRACKET

## SPARE PARTS

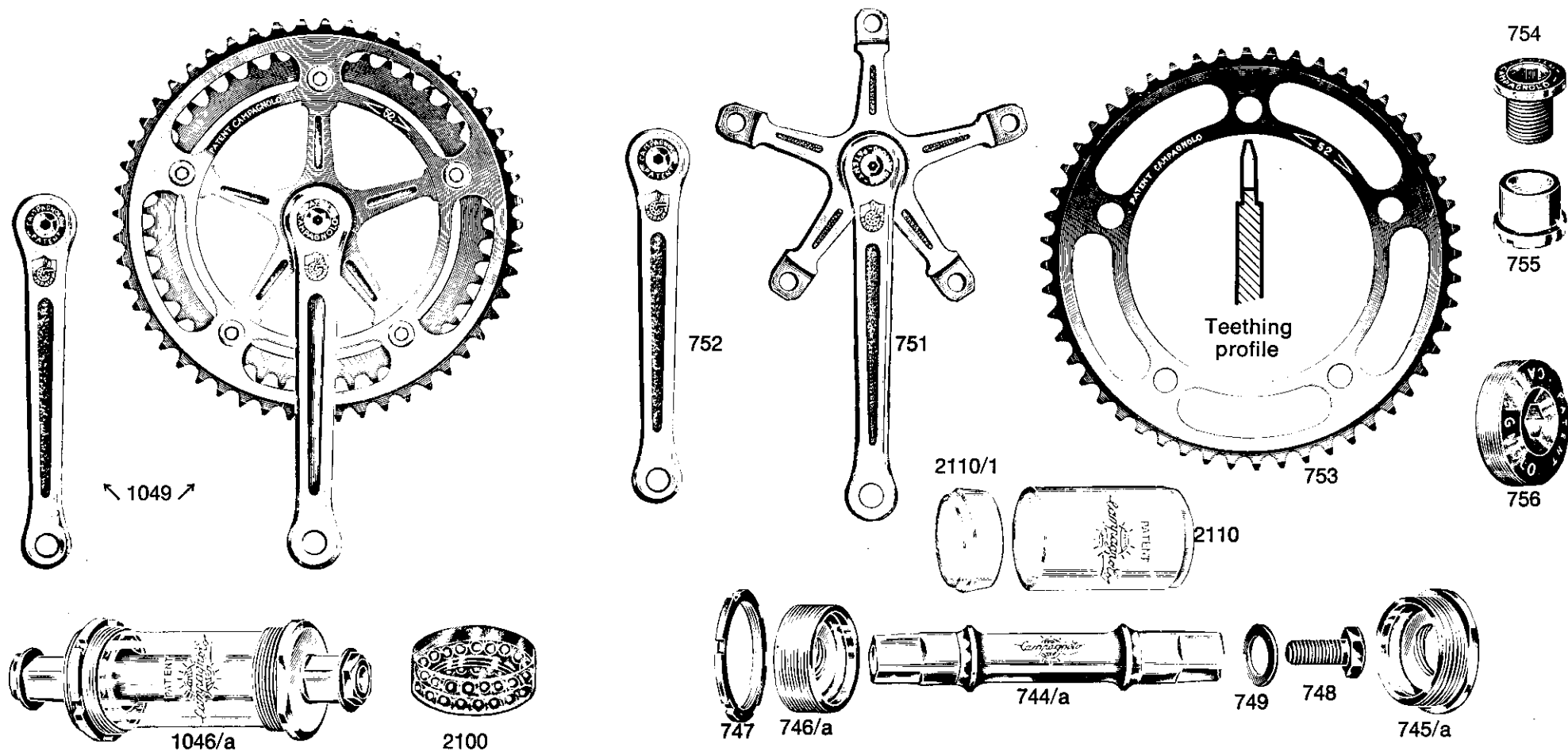

- 1046/a **Cotterless** Nuovo Record bottom bracket (unless otherwise requested it will be supplied with 70-SS-120 spindle and 36 × 24 F. cups)
- 1049 **Road** chainwheel set (unless otherwise requested the set will be supplied with 170 mm. cranks and with 47-50 teeth chainrings for 1/2" × 3/32" chain)

For sizes and details of the Nuovo Record bottom bracket see page No. 25.

- |        |                                |     |   |
|--------|--------------------------------|-----|---|
| 744/a  | <b>Cotterless</b> road spindle | 751 | <b>Road</b> right hand crank (complete with cover No. 756) - please specify length    |
| 745/a  | <b>Fixed</b> cup               | 752 | <b>Road</b> left hand crank (complete with cover No. 756) - please specify length     |
| 746/a  | <b>Adjustable</b> cup          | 753 | <b>Road</b> chainring for 1/2" × 3/32" (2 mm.) chain. Please specify number of teeth. |
| 747    | <b>Lock</b> ring               | 754 | <b>Road</b> chainwheel fastening screw  |
| 748    | <b>Fixing</b> screw            | 755 | <b>Road</b> chainwheel fastening nut  |
| 749    | <b>Fixing</b> washer           | 756 | <b>Crank</b> cover plate  |
| 2110   | <b>Record</b> sleeve           |     |   |
| 2110/1 | <b>Cone</b> for Record sleeve  |     |   |

CRANKS: LENGTH 165 - 167.5 - 170 - 172.5 - 175 - 177.5 - 180mm.

CHAINRINGS: FOR 1/2" CHAIN - FROM 42 TO 57 TEETH

# 1050 - RECORD CHAINWHEEL SET - TRACK BOTTOM BRACKET

## SPARE PARTS

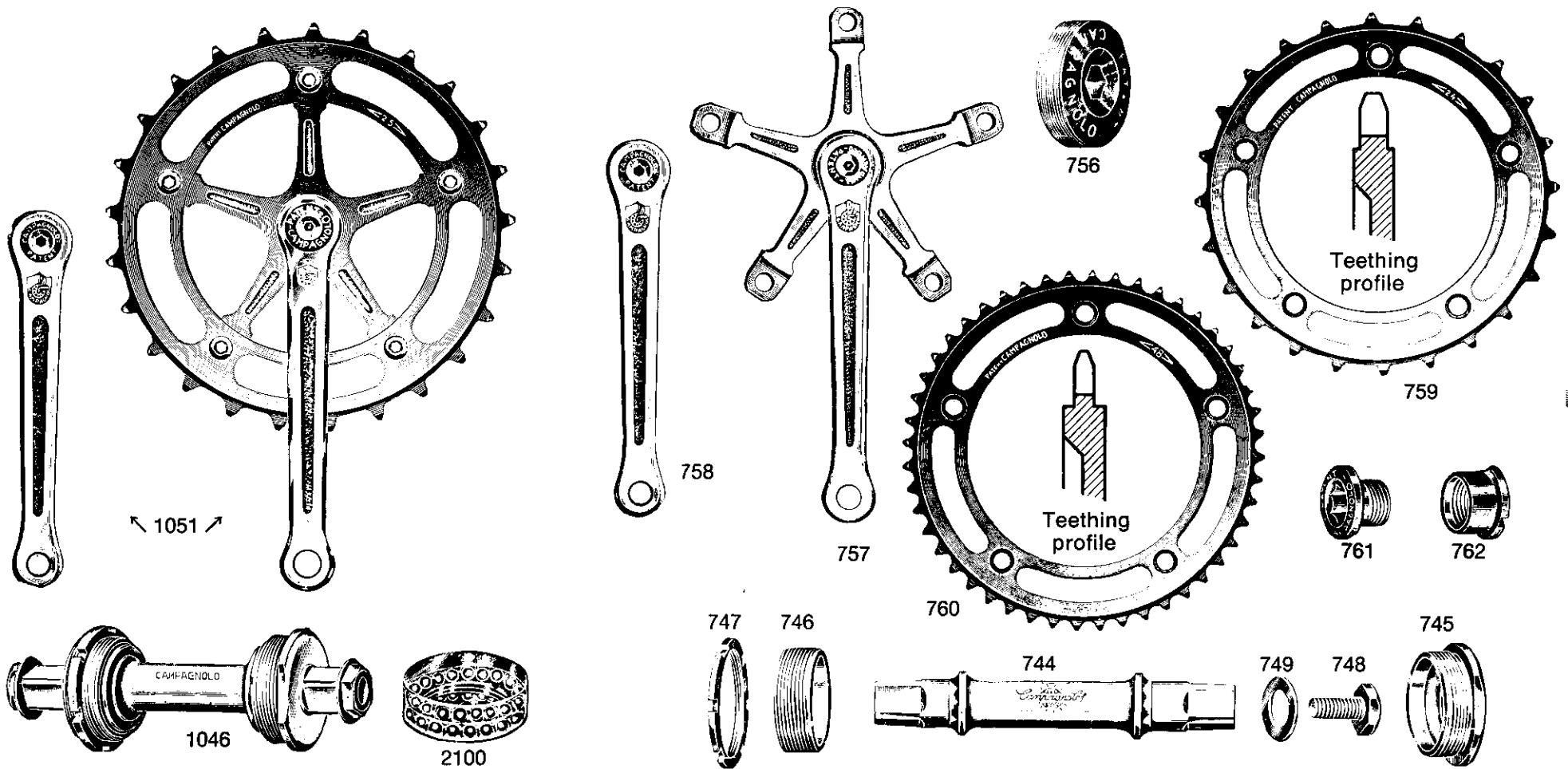

1046 **Cotterless** Record bottom bracket (unless otherwise requested it will be supplied with 65-P-110 spindle and 36 x 24 F. cups)

1051 **Track** chainwheel set (unless otherwise requested it will be supplied with 170 mm. cranks and with 24 teeth chainrings for 1" x 3/16" (4.6 mm.) chain)

**CRANKS: LENGTH 165 - 167.5 - 170 - 172.5 - 175 - 177.5 - 180 mm.**

**CHAINRINGS: FOR 1" CHAIN - FROM 22 TO 35 TEETH  
FOR 1/2" CHAIN - FROM 44 TO 70 TEETH**

**For sizes and details of the Record bottom bracket see page No. 24**

744 **Cotterless** road spindle  
745 **Fixed** cup  
746 **Adjustable** cup  
747 **Lock** ring  
748 **Fixing** screw  
749 **Fixing** washer

756 **Crank** cover plate  
757 **Track** right hand crank (complete with cover No. 756) - please specify length  
758 **Track** left hand crank (complete with cover No. 756) - please specify length  
759 **Track** chainring for 1" x 3/16" (4.6 mm.) chain - also available for 1" x 1/8" (3 mm.) chain. Please specify number of teeth  
760 **Track** chainring for standard chain 1/2" x 1/8" (3 mm.) - Please specify number of teeth.  
761 **Track** chainwheel fastening screw  
762 **Track** chainwheel fastening nut

# CAMPAGNOLO ROAD SPECIAL CHAINWHEEL SETS

RIGHT HAND CRANK WITH TRIPLE CHAINRING

CYCLOCROSS RIGHT HAND FLANGED CRANK

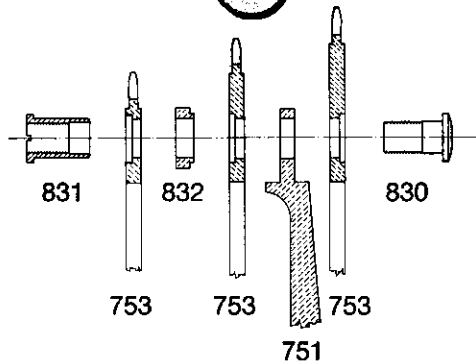
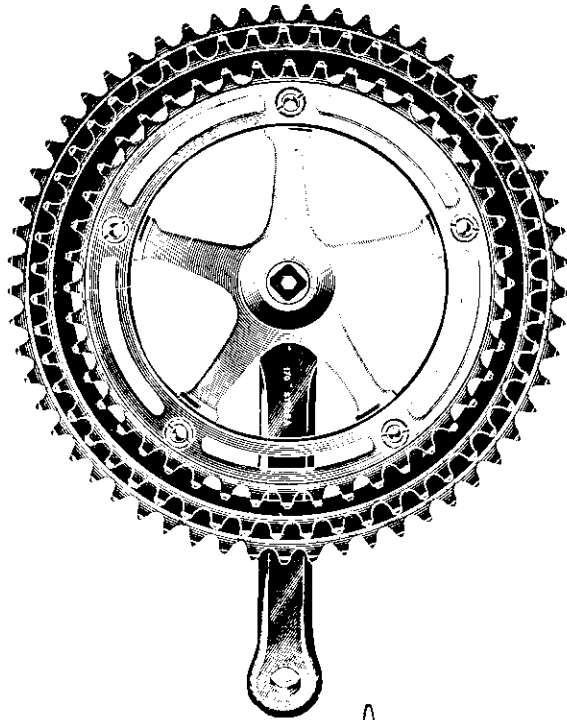

- 751 **Road** right hand crank (complete with cover No. 756)  
Please specify length
- 753 **Chainring** for 1/2" × 3/32" chain (2 mm.)  
Please specify number of teeth
- 830 **Triple** chainring fixing bolt
- 831 **Nut** for bolt No. 830
- 832 **Triple** chainring spacer

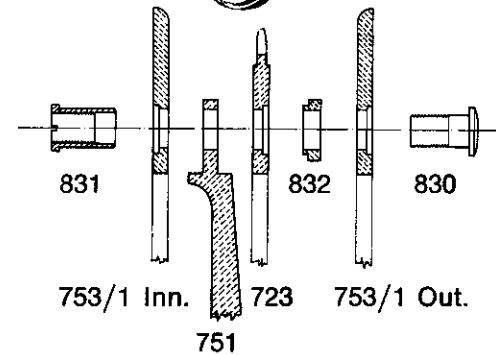
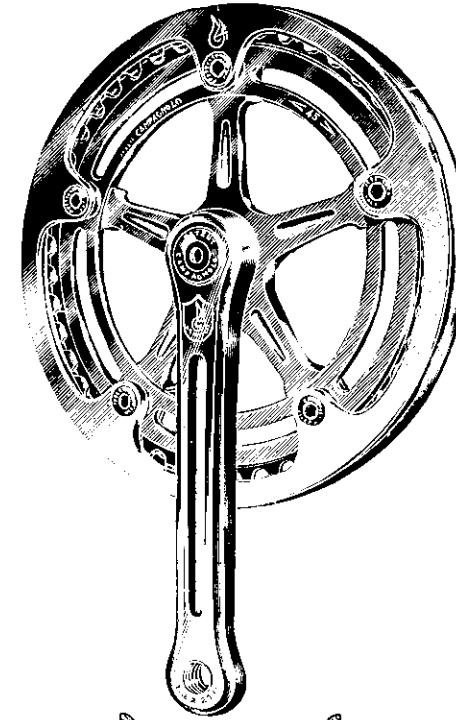

- 751 **Road** right hand crank (complete with cover N. 756)  
Please specify length
- 753 **Chainring** for 1/2" × 3/32" chain (2 mm.)  
Please specify number of teeth
- 753/1 **Cyclocross** inner flange
- 753/1 **Cyclocross** outer flange
- 830 **Triple** chainring fixing bolt
- 831 **Nut** for bolt No. 830
- 832 **Triple** chainring spacer



# CAMPAGNOLO ROAD SPECIAL CHAINWHEEL SETS SPARE PARTS

## SPARE PARTS

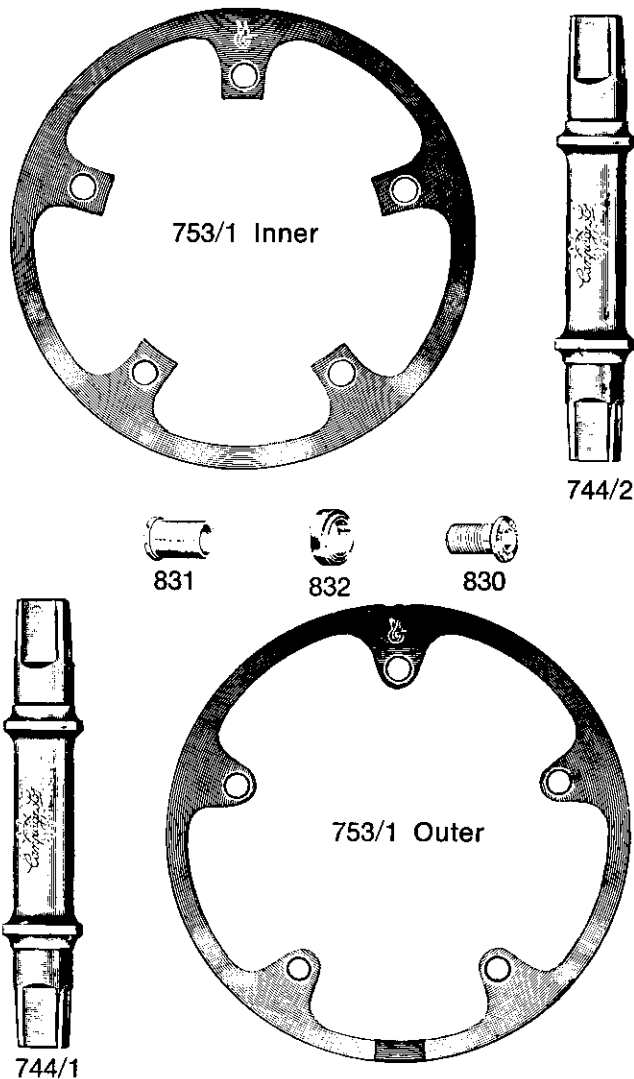

## SLEEVED CRANK FOR 42 TEETH CHAINRING

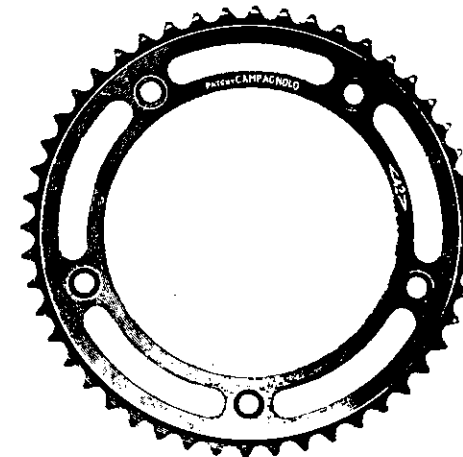
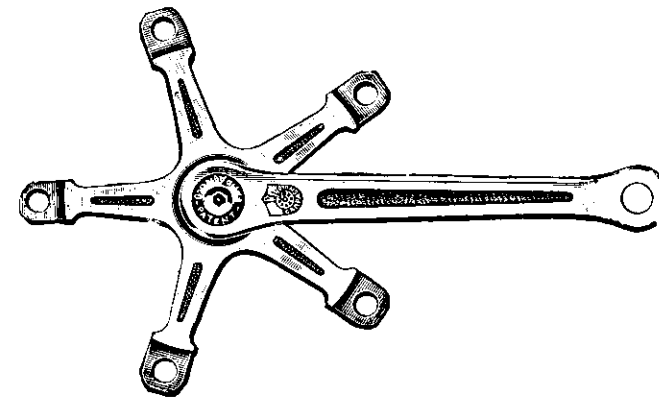

- 744/1 Triple chainerless spindle
- 744/2 Cyclocross coterless spindle
- 753/1 Cyclocross inner flange
- 753/1 Cyclocross outer flange
- 830 Triple chainerless fixing bolt
- 831 Nut for bolt No. 830
- 832 Triple chainerless spacer

**IMPORTANT:** When ordering spare chainrings specify if are to be fitted on cranks for chainrings with 42 teeth onwards or from 44 teeth onwards.

# 1046 - CAMPAGNOLO RECORD BOTTOM BRACKET SET

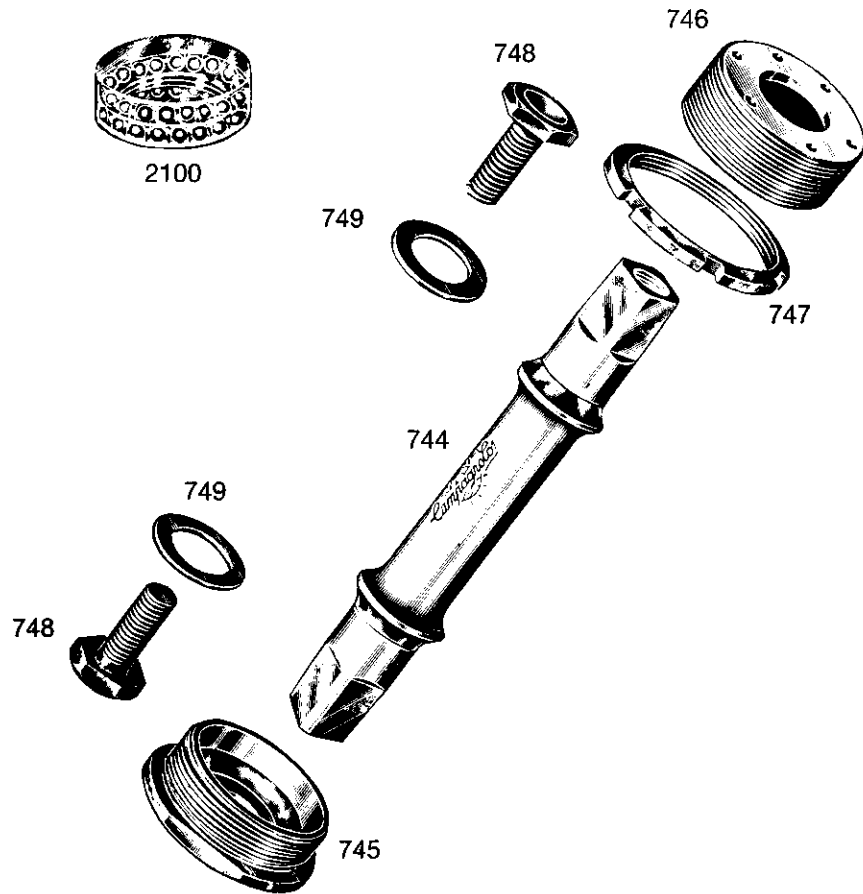

- 744 **Cotterless** road spindle
- 745 **Fixed** cup
- 746 **Adjustable** cup
- 747 **Lockring** 3.5 mm. standard size  
(available also in 4 and 4.5 mm.)
- 748 **Fixing** screw
- 749 **Fixing** washer
- 2100 **Bottom** bracket special ball races

- Ø 36 × 24F. right hand - right hand
- Ø 35 × 1 right hand - right hand
- Ø 1.370 × 24F. BSC right hand - left hand

	BRACKET SERIAL NUMBER		BRACKET WIDTH		AXLE OVERALL LENGTH
TRACK	65-P-110	16	3,5	65	104 mm
	68-P-110	14,5	3,5	68	105 mm
	68-P-120	17	3,5	68	109 mm
	70-P-120	16	3,5	70	109 mm
ROAD	68-SS-120	17	3,5	68	112 mm
	70-SS-120	17	3,5	70	113 mm
	74-SS-120	17	3,5	74	117 mm

Details of the bracket serial number (ex.: 65-P-110)

- The number (65) indicates the bracket width
- (P) indicates track
- (SS) indicate road
- The number (110) indicates the suggested width of the rear hub for a perfect chain line (see pages 40-41)

**BRACKET SETS ORDERED WITHOUT SPECIFICATION WILL BE SUPPLIED AS FOLLOWS:**

**For ROAD**

- Axle 70-SS-120
- Cups Ø 36 × 24 F.

**For TRACK**

- Axle 65-P-110
- Cups Ø 36 × 24 F.

CUPS WITH A 0,5 mm. INCREASED THREAD AVAILABLE

# 1046/a - CAMPAGNOLO NUOVO RECORD

## BOTTOM BRACKET SET WITH SPECIAL AXLE AND CUPS

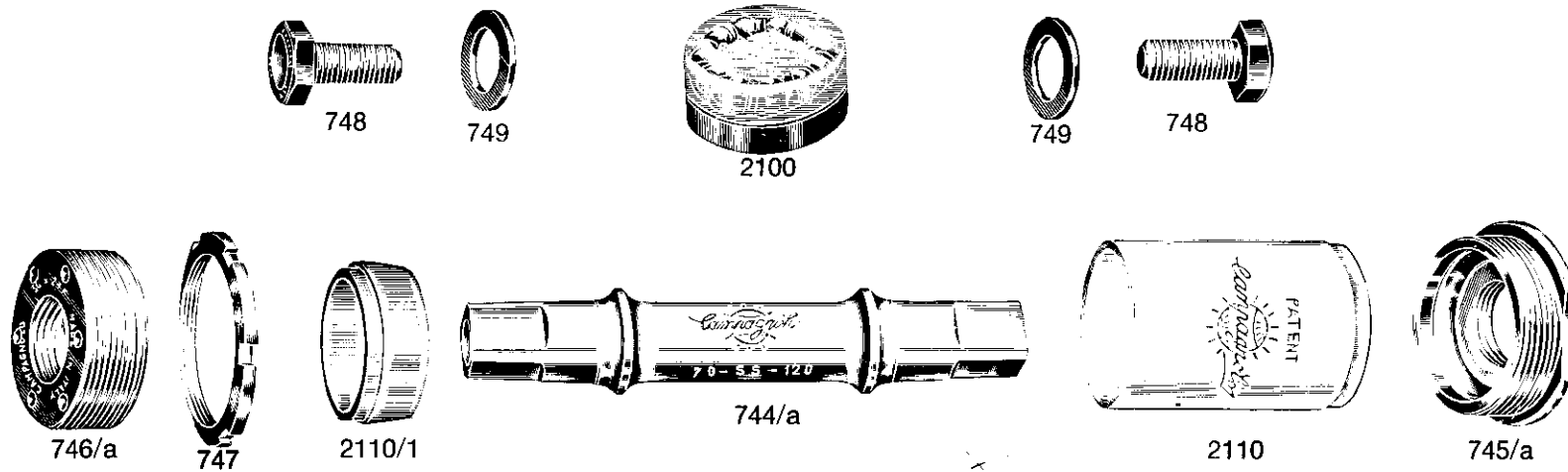

- 744/a **Cotterless** road spindle
- 745/a **Fixed** cup
- 746/a **Adjustable** cup
- 747 **Lockring** 3.5 mm. standard size  
(available also in 4 and 4.5 mm.)
- 748 **Fixing** screw
- 749 **Fixing** washer
- 2100 **Bottom** bracket special ball races
- 2110 **Record** sleeve
- 2110.1 **Cone** for Record sleeve

⌀ 36×24F. right hand - right hand  
 ⌀ 35×1 right hand - right hand  
 ⌀ 1.370×24F. B.S.C. right hand - left hand

### CUPS WITH A 0,5 mm. INCREASED THREAD AVAILABLE

Details of the bracket serial number (ex. 68-SS-120)

- the number (68) indicates the width
- (SS) indicate road
- the number (120) indicates the suggested width of the rear hub for a perfect chain line (see pages 40-41)

### BRACKET SETS ORDERED WITHOUT SPECIFICATION WILL BE SUPPLIED AS FOLLOWS:

- 70-SS-120 axle
- cups thread ⌀ 36×24F.

	BRACKET SERIAL NUMBER		BRACKET WIDTH		AXLE OVERALL LENGTH
ROAD	68 - SS - 120	17 3,5	68	3,5 20	mm. 112
	70 - SS - 120	17 3,5	70	3,5 19	mm. 113

# CAMPAGNOLO RECORD HEADSET

1039 ROAD TYPE

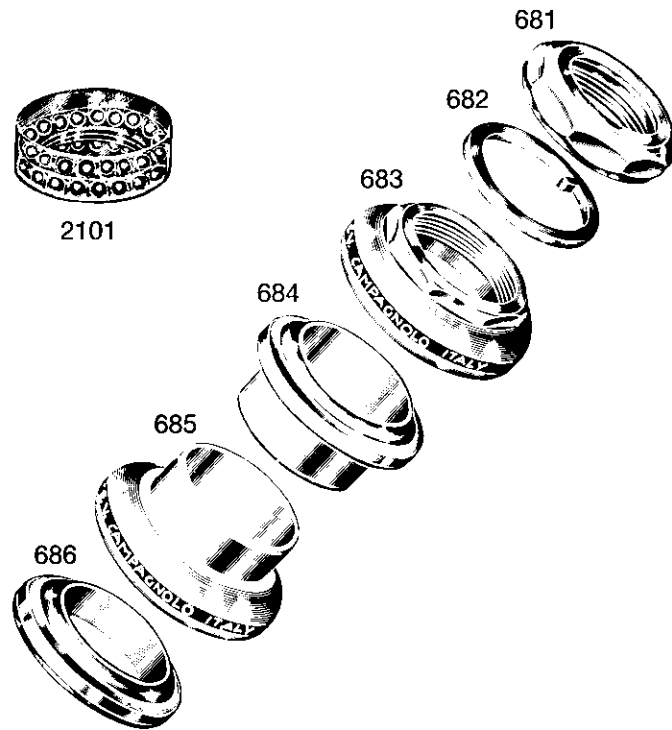

1040 TRACK TYPE

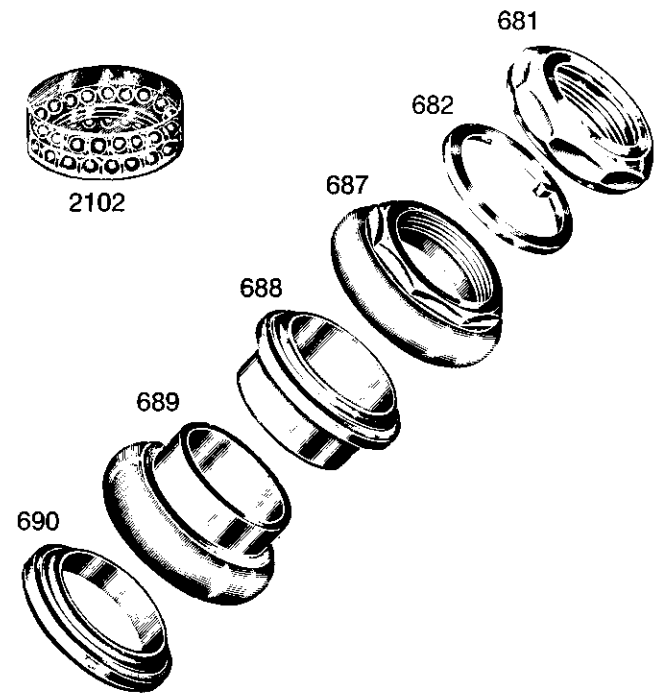

693/1

- 681 Locking nut
- 682 Locking washer
- 683 Screwed race
- 684 Top head race (0.5 mm. larger gauge available)
- 685 Bottom head race (0.5 mm. larger gauge available)
- 686 Crown race (smaller diameter available)
- 693/1 Steerer
- 2101 Road headset special ball races

- 681 Locking nut
- 682 Locking washer
- 687 Track screwed race
- 688 Top head race (0.5 mm. larger gauge available)
- 689 Bottom head race (0.5 mm. larger gauge available)
- 690 Crown race (smaller diameter available)
- 2102 Track headset special ball races

HEADSET ORDERED WITHOUT SPECIFICATION WILL BE SUPPLIED WITH  $\varnothing 25.4 \times 24F.$  THREAD  
HEADSETS WITH  $\varnothing 25 \times 1$  AND  $\varnothing 1" \times 24$  T.P.I. B.S.C. THREADS AVAILABLE

CAMPAGNOLO HEADSETS ARE SUPPLIED COMPLETE WITH SPECIAL BALL RACES ( $\varnothing 3/16"$  FOR ROAD AND  $\varnothing 5/32"$  FOR TRACK)

STEERER AVAILABLE WITH THREAD  $\varnothing 25.4 \times 24F.$  AND WITH LENGTHS 160-180-200-220-250-270 mm.

# CAMPAGNOLO RECORD PEDALS

## 1037 ROAD TYPE

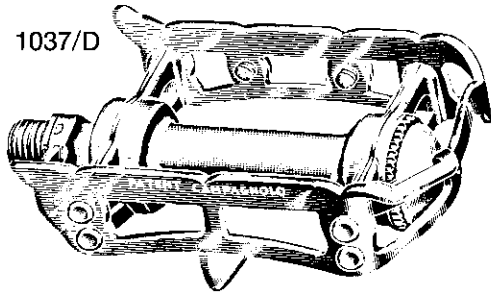

1037/D

1037/D **Road** right hand pedal

1037/S **Road** left hand pedal

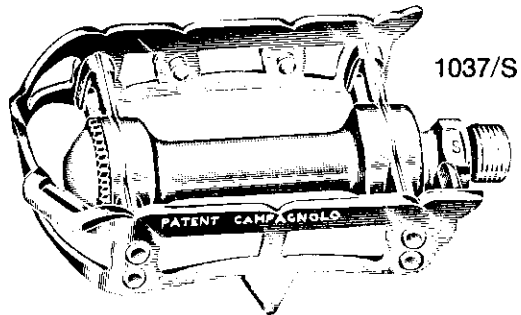

1037/S

## 1038 TRACK TYPE

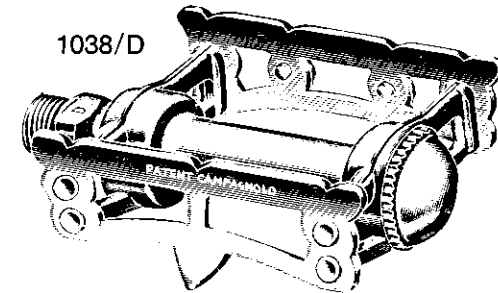

1038/D

1038/D **Track** right hand pedal

1038/S **Track** left hand pedal

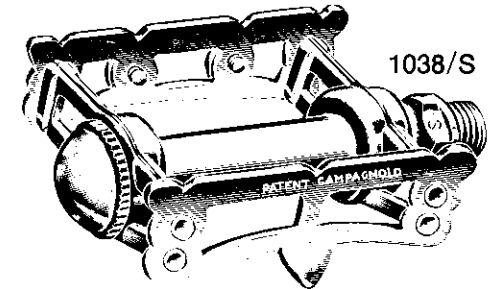

1038/S

## SPARE PARTS

- 669 **Left hand pedal axle**
- 670 **Right hand pedal axle**
- 672 **Inserted race**
- 673 **Pedal axle washer**
- 674 **Pedal axle cone**
- 675 **Pedal axle lock nut**
- 676 **Toe clip bolt**
- 677 **Toe clip washer**
- 678 **Inner dust cap**
- 679 **Pedal dust cap**
- 2103 **Pedal special ball races**

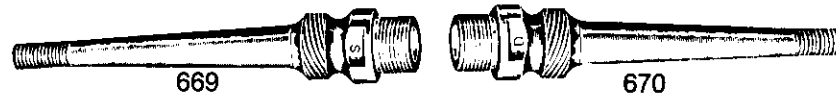

672



673



674



675



676



677



678



679



2103

UNLESS OTHERWISE REQUESTED, PEDALS WILL BE SUPPLIED WITH  $\varnothing$  9/16"  $\times$  20F. SPINDLE  
 PEDALS WITH  $\varnothing$  14  $\times$  1,25 SPINDLES THREAD AVAILABLE

# 2040 - CAMPAGNOLO RECORD BRAKES AND CONTROL LEVERS

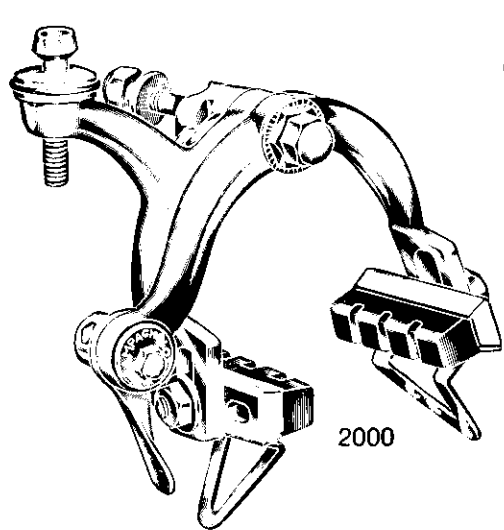

2000 Front brake

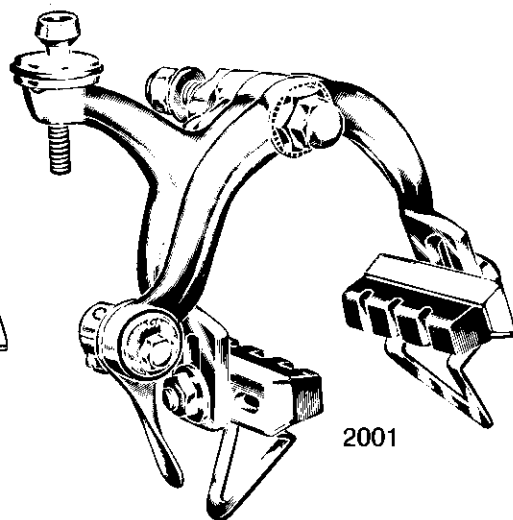

2001 Rear brake

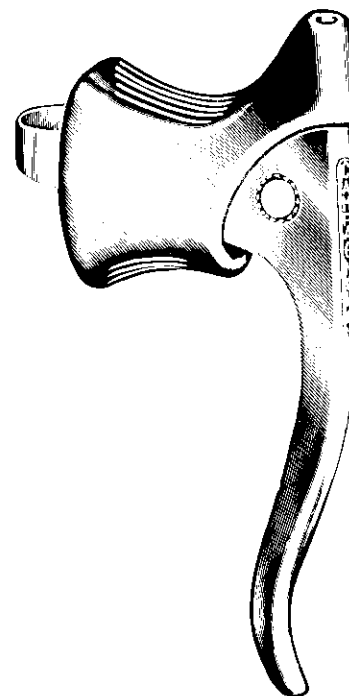

2030 Brake quick release lever

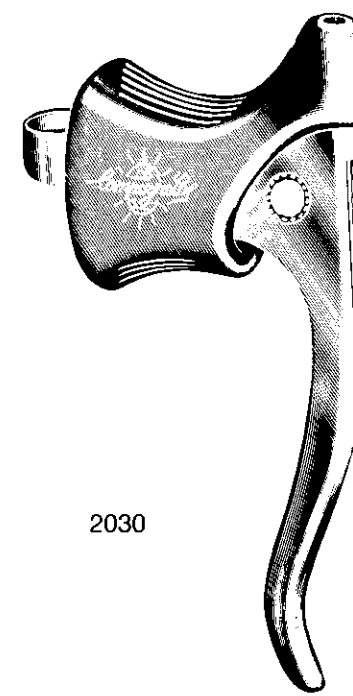

2030

IF REQUESTED OUTER CASINGS AND CABLES ARE FURNISHED INCREASED OF 6 cm (SEE NORMAL MEASURES AT PAGE 29)

# CAMPAGNOLO RECORD BRAKES AND CONTROL SYSTEM SPARE PARTS

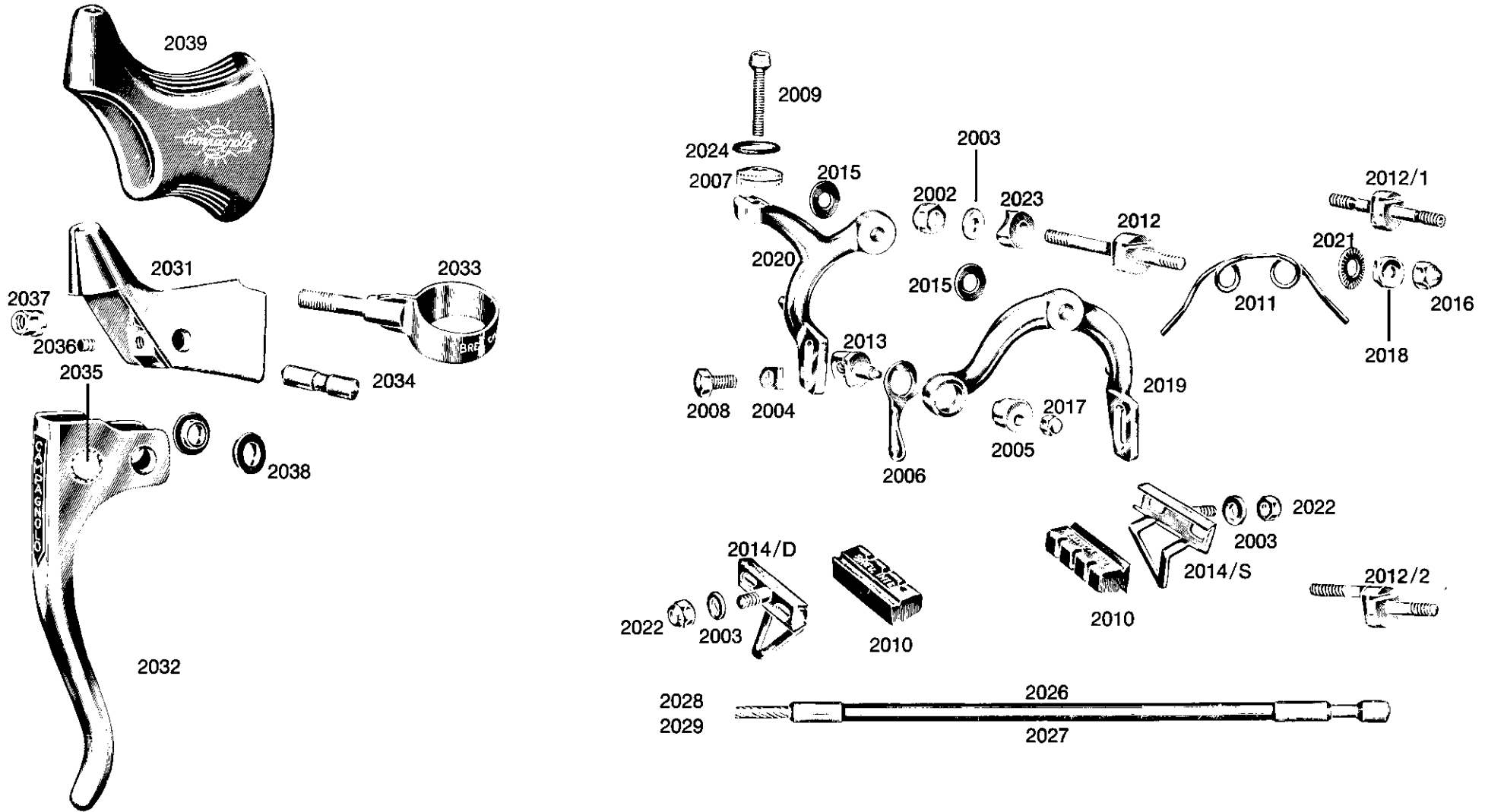

- 2002 Centre bolt fixing nut
- 2003 Brake shoe washer
- 2004 Clamp bolt washer
- 2005 Cam
- 2006 Quick release cam lever
- 2007 Adjusting nut
- 2008 Cable clamp bolt
- 2009 Adjusting screw
- 2010 Brake block
- 2011 Tension screw
- 2012 Front brake centre bolt
- 2012/1 Rear brake centre bolt
- 2012/2 Rear brake centre bolt

- 2013 Cable clamp
- 2014/D Right hand brake shoe
- 2014/S Left hand brake shoe
- 2015 Friction washer
- 2016 Domed nut
- 2017 Cam locking nut
- 2018 Locking nut
- 2019 Front stirrup
- 2020 Rear stirrup
- 2021 Serrated washer
- 2022 Brake shoe nut
- 2023 Concave washer
- 2024 Adjusting rubber

- 2026 Front brake outer cable (56 cm.)
- 2027 Rear brake outer cable (114 cm.)
- 2028 Front inner cable (68 cm.)
- 2029 Rear inner cable (126 cm.)
- 2031 Lever hood
- 2032 Lever
- 2033 Brake lever clip
- 2034 Lever pivot pin
- 2035 Cable nipple holder
- 2036 Grub screw
- 2037 Clamp nut
- 2038 Lever bush
- 2039 Rubber lever hood

# CAMPAGNOLO SEAT PIN

1044 FOR WIDE CRADLE SADDLES  
WITH SHORT ADJUSTMENT



## SPARE PARTS

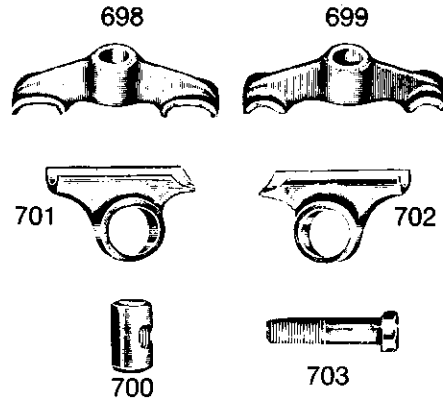

- 698 Front bracket
- 699 Rear bracket
- 700 Bolt nut
- 701 Left hand side support
- 702 Right hand side support
- 703 Fixing and adjusting bolt

1045 FOR NARROW CRADLE SADDLES  
WITH LONG ADJUSTMENT

## SPARE PARTS

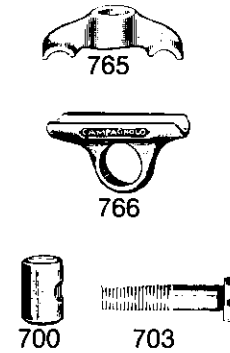

- 700 Bolt nut
- 703 Fixing and adjusting bolt
- 765 Front and rear clamp
- 766 Right and left hand support

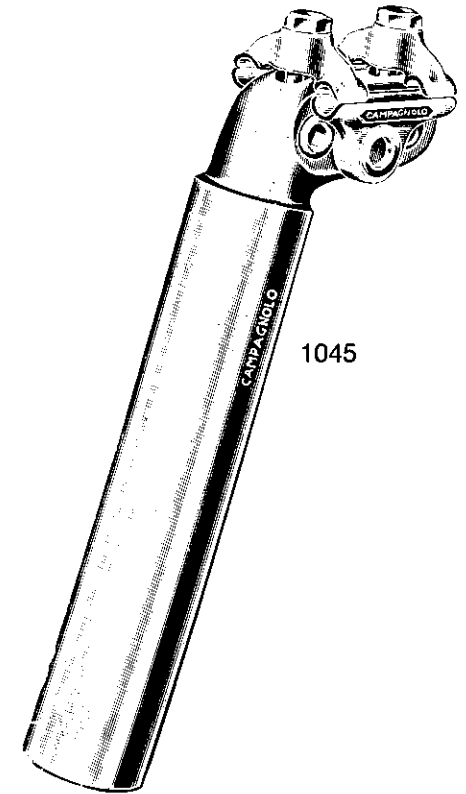

WHEN ORDERING PLEASE SPECIFY:

— PIN DIAMETER AS PER ONE OF THE GIVEN SIZES: 25 - 25.8 - 26 - 26.2 - 26.4 - 26.6 - 26.8 - 27 - 27.2 - 27.4.

— LENGTH OF THE PIN - STANDARD (130 mm.) — LONG (180 mm.)

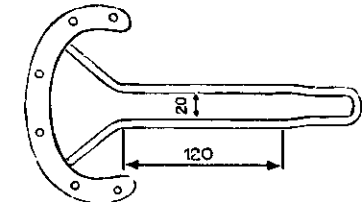
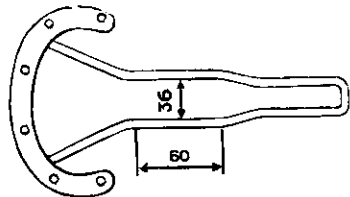



## OUTER AND INNER CABLES

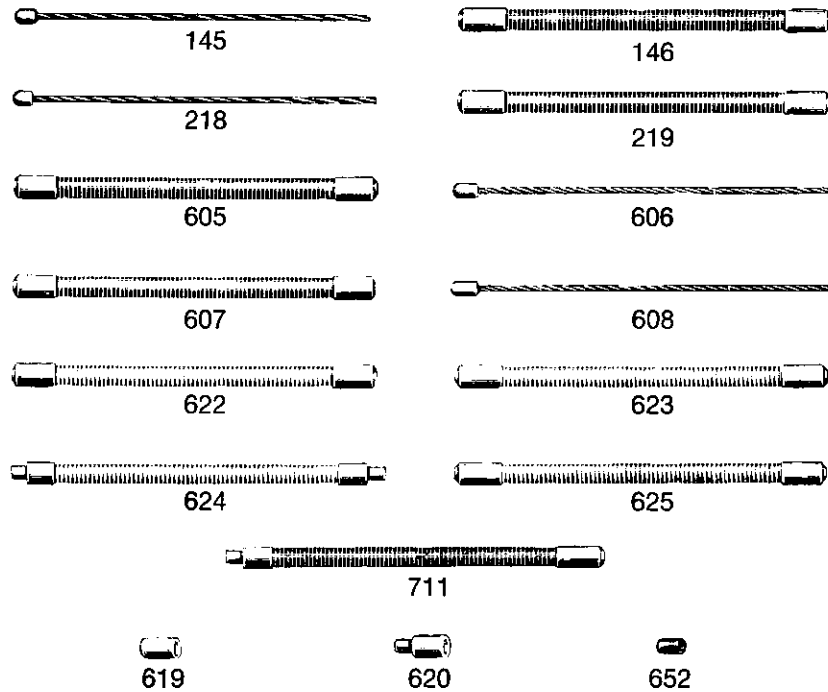

- 145 **Rear** derailleur cable to handlebar control (197 cm.)  
 146 **Rear** derailleur outer casing to handlebar control (185 cm.)  
 218 **Front** changer cable to handlebar control (150 cm.)  
 219 **Front** changer outer casing to handlebar control (140 cm.)  
 605 **Gear** outer casing (105 cm.)  
 606 **Gear** cable to frame control (118 cm.)  
 607 **Down** tube front outer casing (59 cm.)  
 608 **Front** changer cable to frame control (70 cm.)  
 619 **Outer** casing ferrule  
 620 **Spindled** ferrule  
 622 **Rear** derailleur steel outer casing (21 cm.)  
 623 **Front** changer steel outer casing (15.5 cm.)  
 624 **Chainstay** outer casing (10 cm.)  
 625 **Steel** outer casing to down tube handlebar control (75 cm.)  
 652 **Safety** cable  
 711 **Gear** vipla outer casing (23 cm.)

## CLIPS

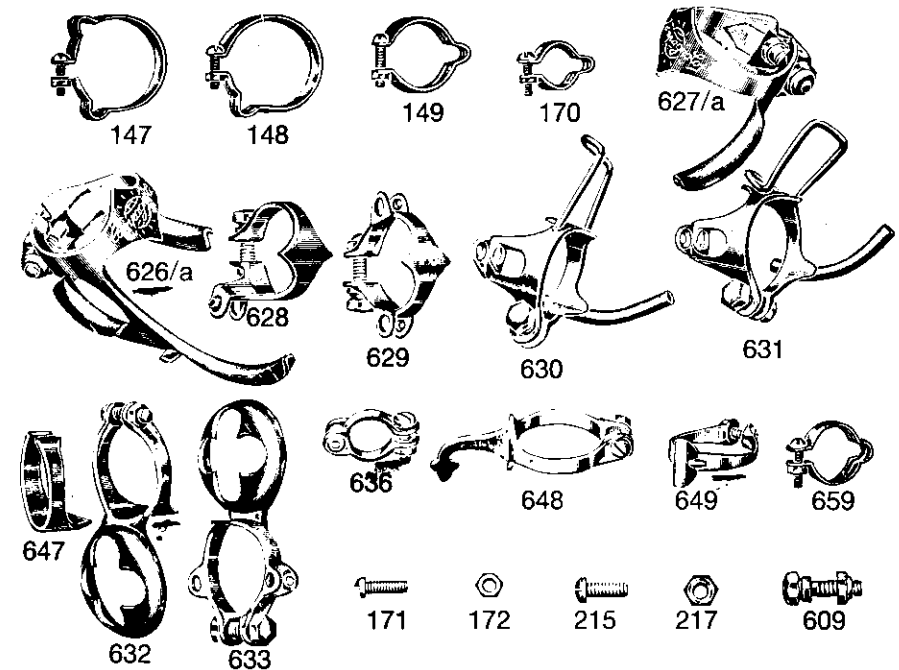

- 147 **Twin** outer cable clip (28 mm.  $\phi$ )  
 148 **Outer** cable clip (28 mm.  $\phi$ )  
 149 **Outer** cable clip (22 mm.  $\phi$ )  
 170 **Outer** cable clip (13 mm.  $\phi$ )  
 171 **Clip** bolt  
 172 **Nut** for bolt 171  
 215 **Cage** spanner bolt  
 217 **Cage** spacer bolt nut  
 609 **Clip** bolt and nut  
 626/a **Double** stop clip for down tube controls  
 627/a **Down** tube tunnel R/H for gear  
 628 **Front** changer clip  
 629 **Double** stop cable clip for handlebar control  
 630 **Clip-on-tunnel** and stop with pump holder D/T  
 631 **Clip-on-tunnel** and stop with pump holder S/T  
 632 **Pump** holder  
 633 **Clip** with pump holder for 10-speed handlebar stops  
 636 **Stop** clip on chainstay for rear derailleur  
 647 **Adaptor** shim when fitting 632 to down tube  
 648 **Pump** peg holder  
 649 **Brake** cable clip  
 659 **Outer** cable clip (15 mm.  $\phi$ )

# CLIPS WITH CAMPAGNOLO QUICK-RELEASES

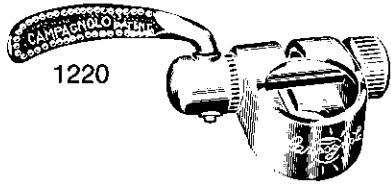

1220 CLIP WITH QUICK-RELEASE

- 1222 Clip body (please specify body diameter)
- 1223 Spindle
- 1224 Adjusting nut
- 1232 Lever
- 1301 Lever block
- 1303 Circlip
- 1304 Tension spring

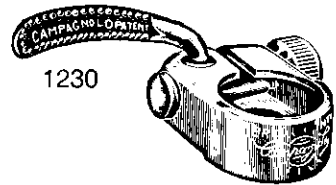
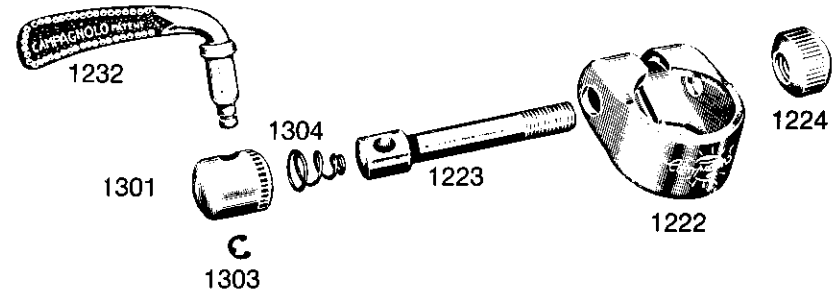

1230 CLIP WITH INCORPORATED QUICK-RELEASE

- 1224 Adjusting nut
- 1231 Clip body (please specify body diameter)
- 1232 Lever
- 1233 Spindle
- 1303 Circlip

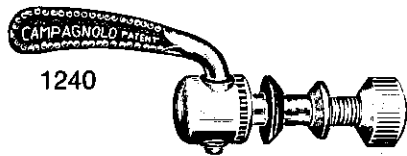
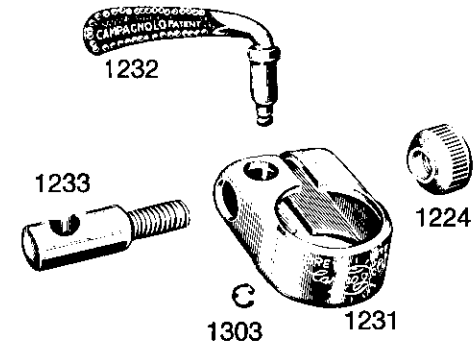

1240 SPECIAL QUICK-RELEASE BOLT

- 1223 Spindle
- 1224 Adjusting nut
- 1225 Spacing washers
- 1232 Lever
- 1301 Lever block
- 1303 Circlip
- 1304 Tension spring

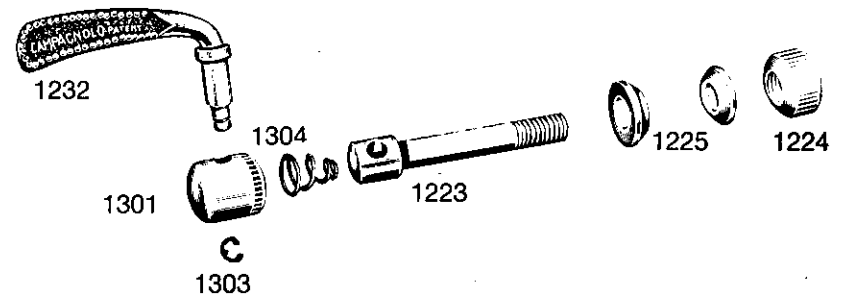

WHEN ORDERING PLEASE ALWAYS SPECIFY THE DESIRED DIAMETER OF CLAMP

# CAMPAGNOLO REAR AND FRONT FORK ENDS

## 1010 RECORD SET

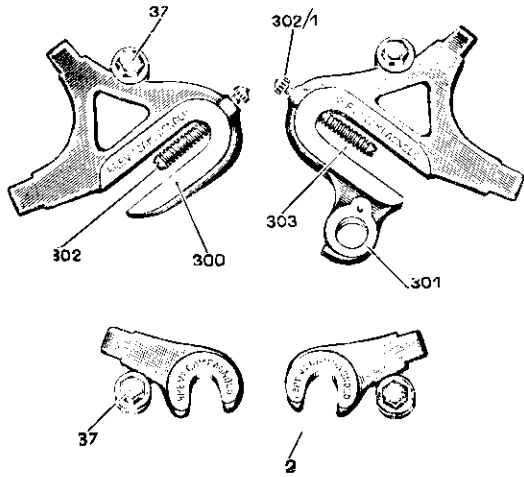

- 2 Front fork ends
- 37 Screw and washer
- 300 Left hand rear end
- 301 Right hand rear end
- 302 Adjusting bolt
- 302/1 Nut for bolt 302
- 303 Adjusting bolt spring

## 1010/1 SPORT SET

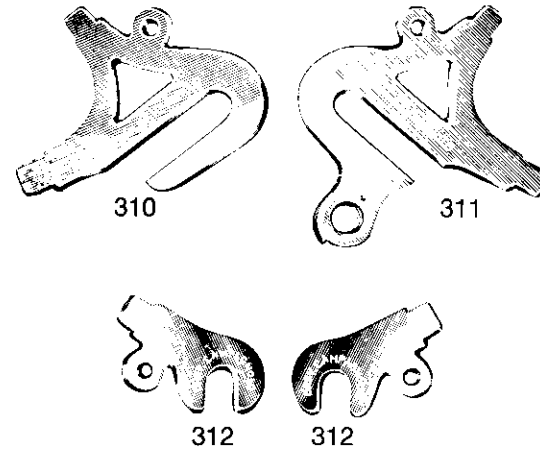

- 310 Left hand rear end
- 311 Right hand rear end
- 312 Front fork ends

## 1053 TRACK SET

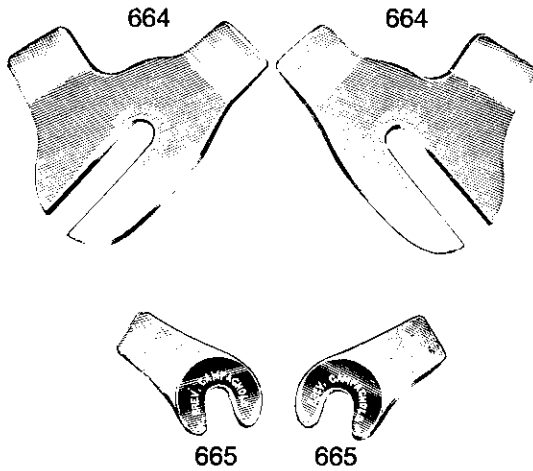

- 664 Rear fork ends
- 665 Front fork ends

## 1060 RACING SET

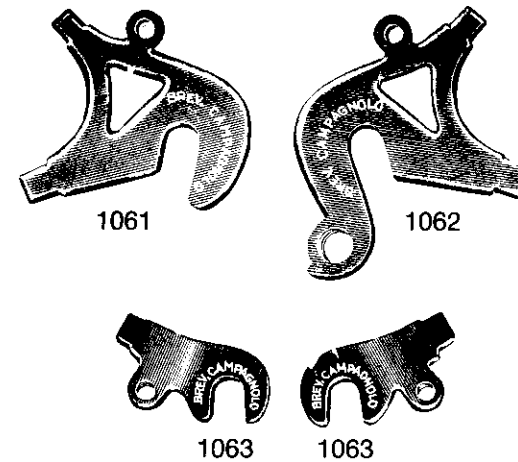

- 1061 Left hand rear end
- 1062 Right hand rear end
- 1063 Front fork ends

## SPECIAL PUMP ADAPTORS

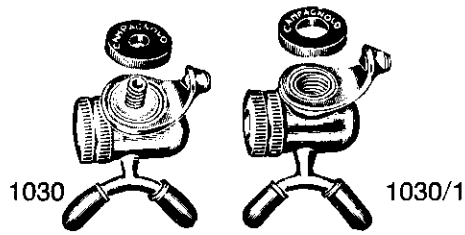

1030 1030/1

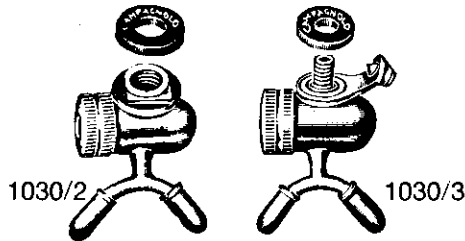

1030/2 1030/3

### SPARE PARTS

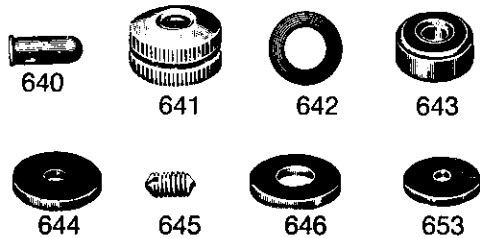

- 640 Rubber cap
- 641 Milled nut
- 642 Rubber washer
- 643 Rubber washer for tubular valves
- 644 Rubber washer for pump connector 1030
- 645 Connecting screw
- 646 Rubber washer for pump connectors 1030 1 and 1030 2
- 653 Rubber washer for pump connector 1030 3
- 1030 Pump connector for British pumps complete with 7/32" or 7/16" x 1 locking screw
- 1030 1 Pump connector for Italian pumps with 9/16" x 1.25 locking screw
- 1030 2 Pump connector for Italian Silca Impero pumps with 9/16" x 1.25 squared boss
- 1030 3 Pump connector for French pumps with 5/16" x 1 or 7/16" x 1 locking screw

## SUNDRIES

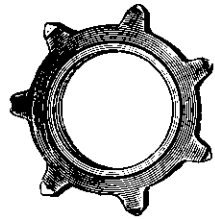

764

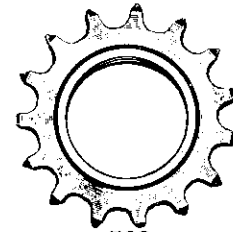

763

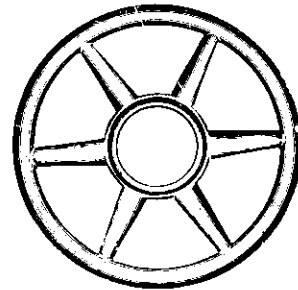

55



651

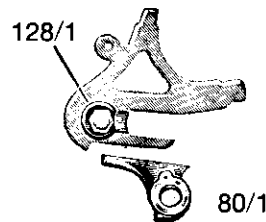

128/1

80/1

- 55 Spoke disc (specify if for 4 or 5 sprockets)
- 80 1 Gear fixing plate
- 128 1 Rear fork end bolt
- 651 Freewheel spacer (1 - 1.5 - 2 mm. thick)
- 763 Standard sprocket for 1/2" x 1.8" (3 mm. chain. (Sprockets with 12 - 13 - 14 - 15 - 16 teeth available)
- 764 Racing chain sprocket for 7/16" x 3/16" (4.6 mm.) chain. (Sprocket with 6 - 7 - 8 or for 1" x 1.8" chain available)

## SPECIAL GREASE



100 GRS. TIN



500 GRS. TIN



1 KG. TIN

# CAMPAGNOLO PUMP CLIP AND SPECIAL PUMP CONNECTOR FOR DIFFERENT POSITIONS

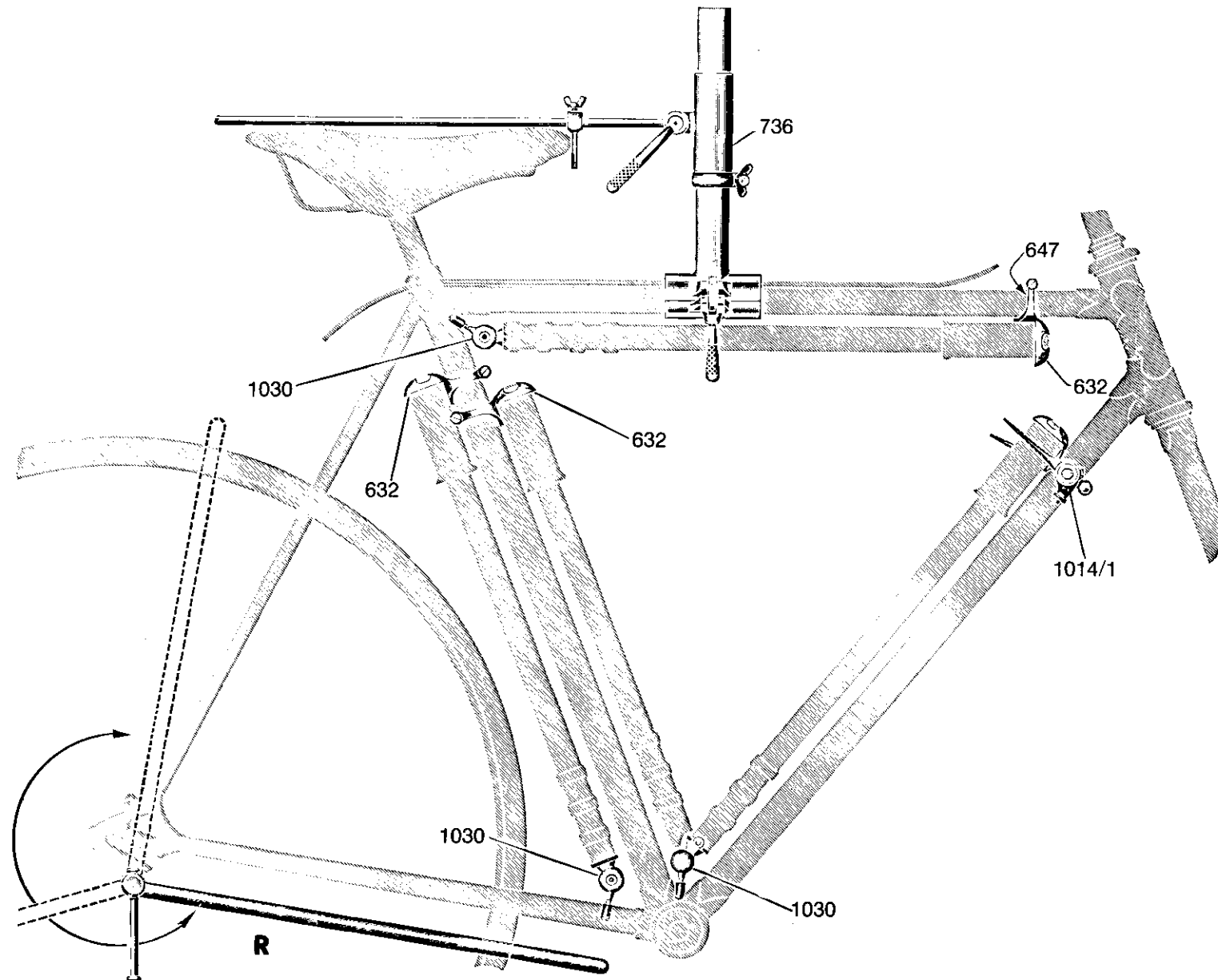

- 632 **Pump** holder
- 647 **Adaptor** shim when fitting 632 to down tube
- 736 **Saddle** line alignment
- 1014/1 **Twin** down tube lever with pump holder
- 1030 **Pump** connector (see models on page 34)
- R **Back** stay tool (see page 37)

# CAMPAGNOLO

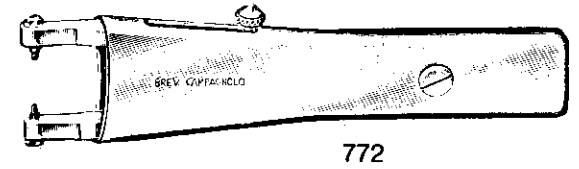
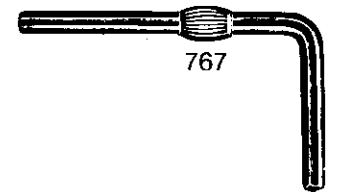
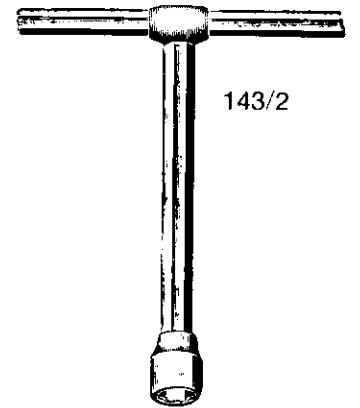
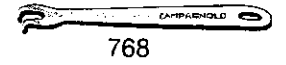
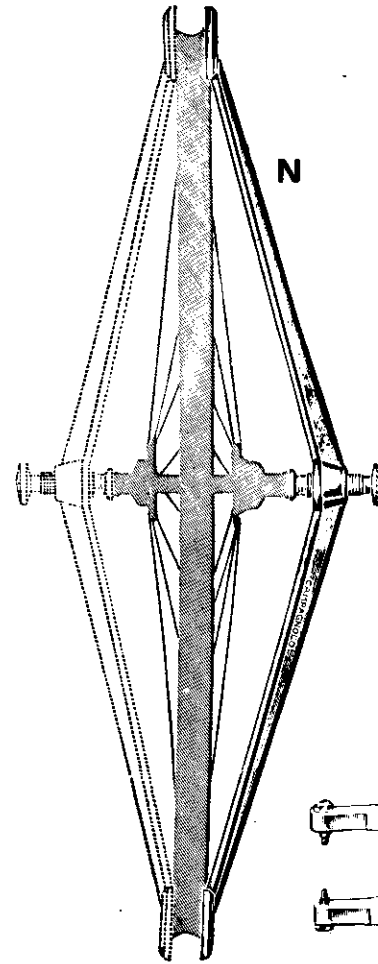
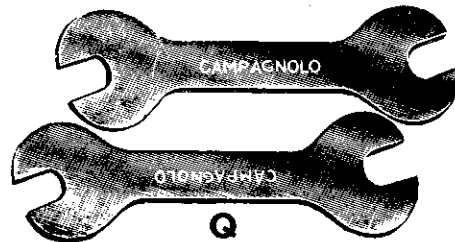
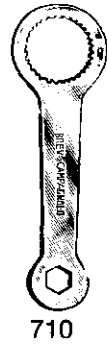
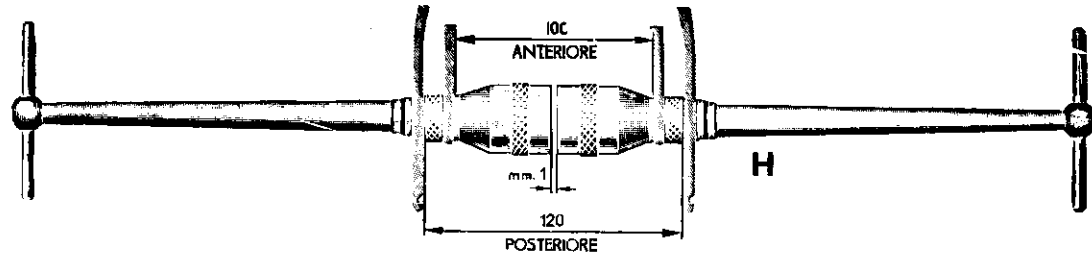

# SPECIAL TOOLS

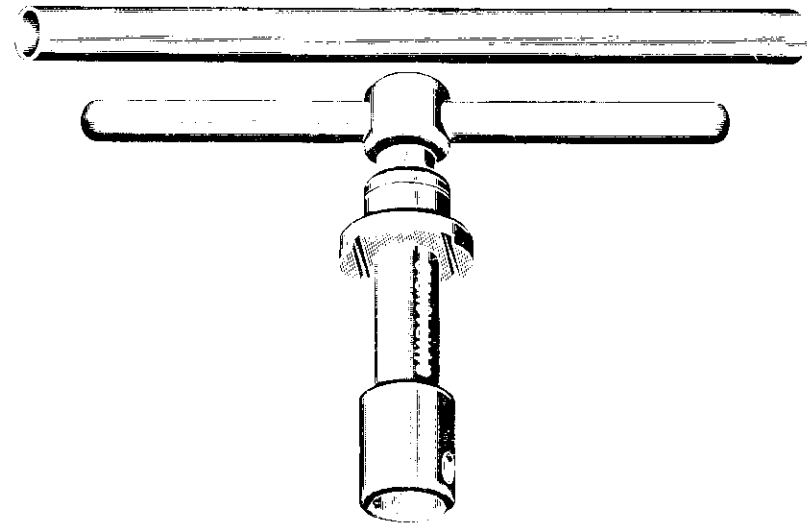
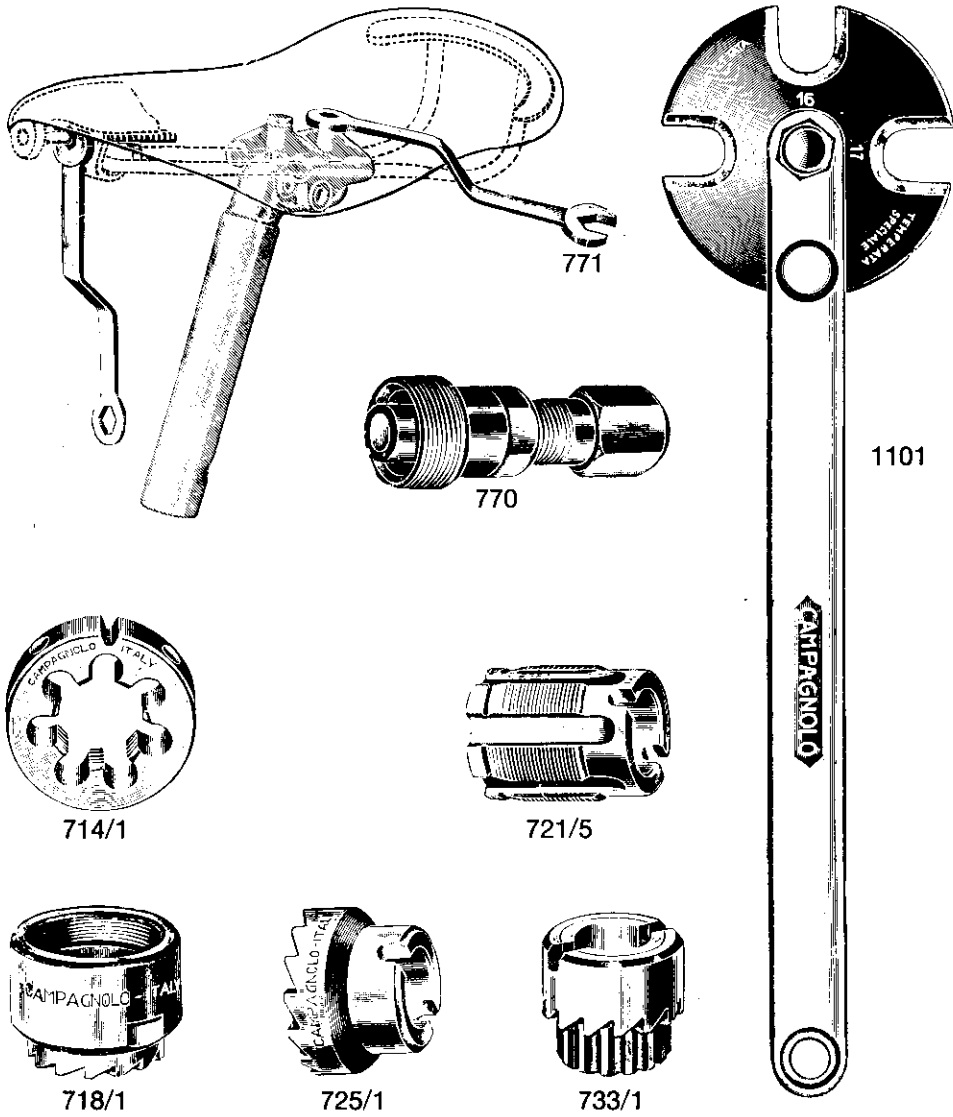

- G **Straight edge**
- H **Back stay alignment tool**
- I **Freewheel removing tool complete**
- N **Wheel dish tool**
- P **Axle holding tool for 9 and 10  $\odot$**
- Q **Cone wrenches (two) 13-14 or 15-16**
- R **Back stay tool**
- 97 **Gear wrenches**
- 143/2 **« T » wrenches (6-8 mm)**
- 704 **Insert for freewheel removing tool fig. I**
- 704/1 **Reducing insert for 13T. freewheel**
- 705 **Pedal tap right hand (9/16"  $\odot$   $\times$  20 thread)**
- 706 **Pedal tap left hand (9/16"  $\odot$   $\times$  20 thread)**
- 707 **Gear hanger tap 10  $\odot$   $\times$  26 thread**
- 708 **Madguard eye tap 5  $\odot$   $\times$  0.8**
- 709 **Rear tip adjuster tap 3  $\odot$   $\times$  0.5**
- 710 **Pedal wrenches**
- 714/1 **Fork column die**
- 718/1 **Head race mill**
- 721/5 **Bottom bracket tap**
- 725/1 **Crown race mill**
- 733/1 **Head race mill**
- 767 **« L » shaped chainwheel screw allen key**
- 768 **Chainwheel screw peg spanner**
- 769 **Cotterless B/B axle spanner**
- 770 **Cotterless crank extractor**
- 771 **Saddle spanner**
- 772 **Headsets pin spanner**
- 793/a **R/H bottom bracket cup remover (complete with pipe and fixing edge)**
- 1101 **Pedals spanner**

**CAMPAGNOLO COMPLETE TOOL CASE**  
**\* CAMPAGNOLO REDUCED TOOL CASE**

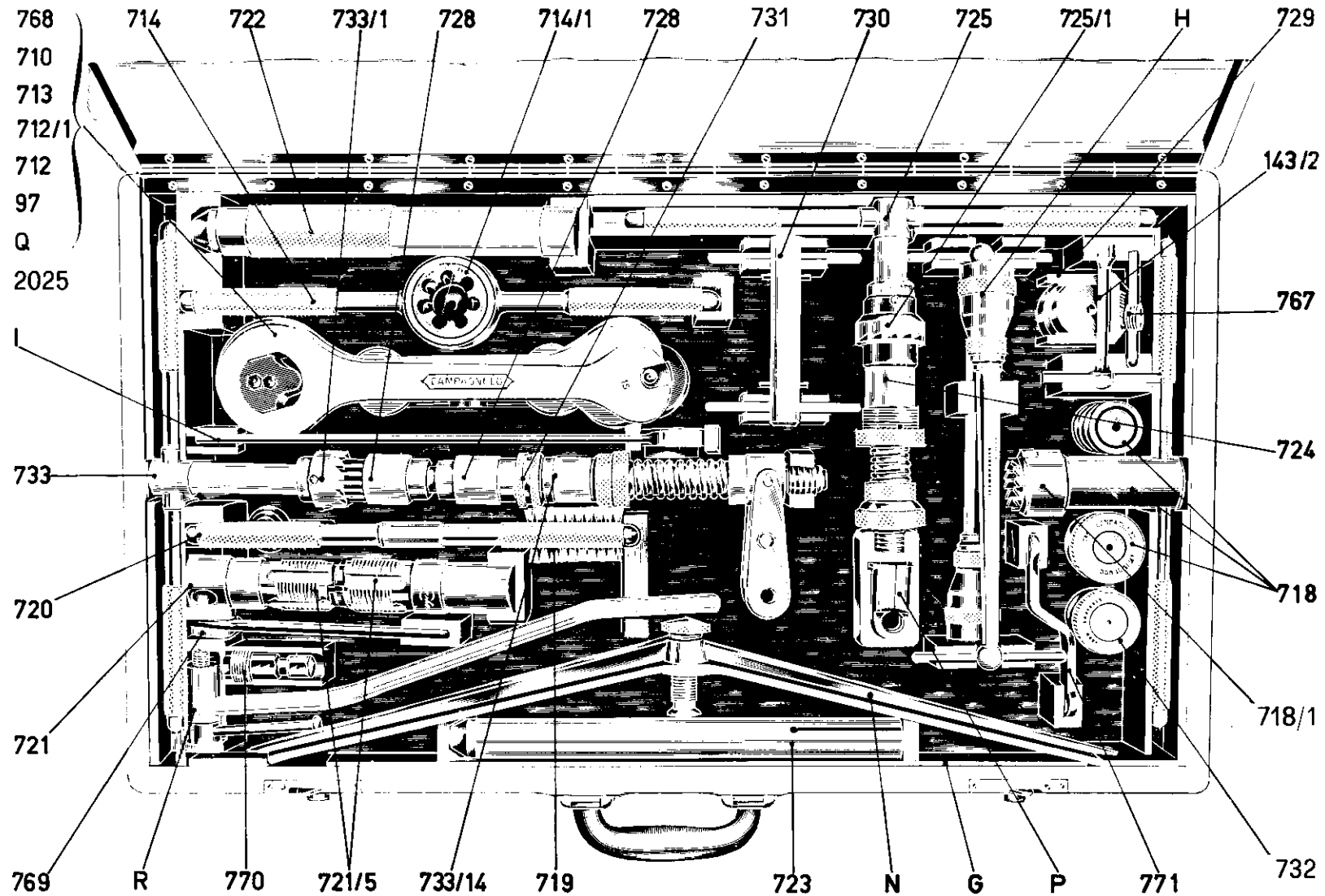

N.B. - THE REDUCED TOOL CASE IS INTENDED FOR ASSEMBLING OF HEADSETS AND BOTTOM BRACKET SETS ONLY



# 1102 - CAMPAGNOLO BICYCLE ASSEMBLING STAND

- 97 **Gear** wrenches
- 143/2 « **T** » wrenches (6-8 mm.)
- 710 **Pedal** wrenches
- \* 712 **Bottom** bracket lockring tool
- \* 712/1 **Bottom** bracket adjusting cone tool
- \* 713 **Bottom** bracket stationary cone tool
- 714 **Fork** column die holder
- 714/1 **Fork** column die
- \* 718 **Crown** race cutter
- \* 718/1 **Head** race mill
- 719 **Brush**
- \* 720 **Handle** for bottom bracket double tap
- \* 721 **Bottom** bracket double tap
- \* 721/5 **Spare** taps for art. 721
- \* 722 **Headset** cup punch
- 723 **Headset** cup remover
- \* 724 **Bottom** bracket cutter sleeve
- 725 **Bottom** bracket face cutter
- \* 725/1 **Spare** mill for art. 725
- \* 728 **Sleeve** for art. 733
- \* 729 **Fork** crown cone remover
- \* 730 **Set** of keys for sleeve No. 724
- 731 **Headset** jig
- 732 **Fork** crown jig
- \* 733/1 **Head** race mill
- \* 733/14 **Centraliser** sleeve for jig 733
- \* 767 « **L** » shaped chainwheel screw allen key
- 768 **Chainwheel** screw peg spanner
- 769 **Cotterless** B/B axle spanner
- \* 770 **Cotterless** crank extractor
- 771 **Saddle** spanner
- 2025 **Special** brake spanner
- G **Straight** edge
- H **Back** stay alignment tool
- I **Freewheel** removing tool complete
- N **Wheel** dish tool
- P **Axle** holding tool
- Q **Cone** wrenches (two) (13-14 mm.)
- R **Back** stay tool



# ROAD CHAIN LINE

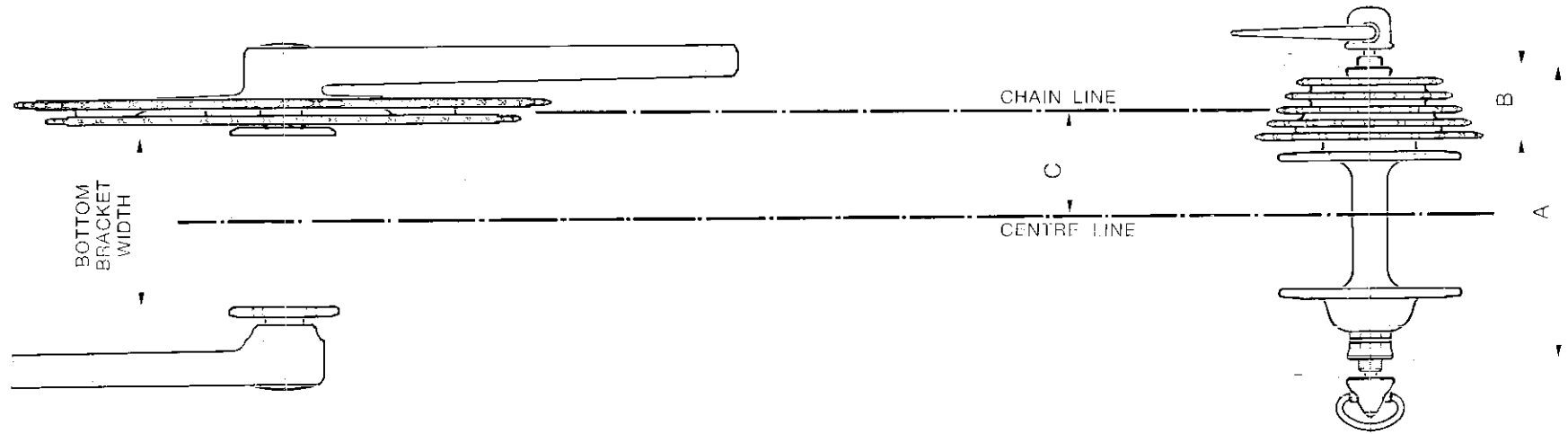

BOTTOM BRACKET WIDTH	REAR HUB WIDTH « A »	FREEWHEEL WIDTH « B »	CHAIN LINE « C »
68	120	29	<b>43,5</b>
70	120	29	<b>43,5</b>
74	120	29	<b>43,5</b>

# TRACK CHAIN LINE

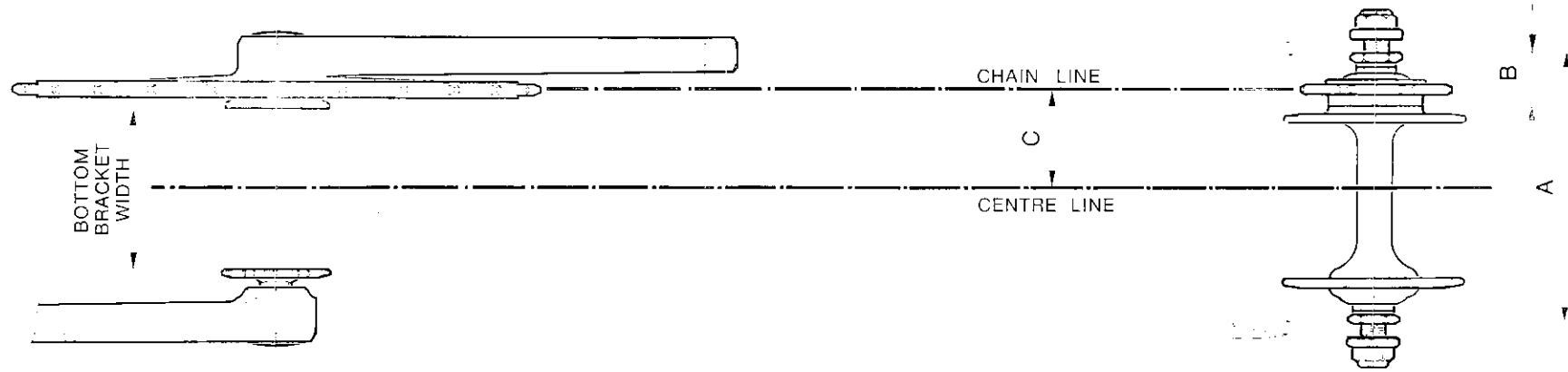

BOTTOM BRACKET WIDTH	REAR HUB WIDTH « A »	SPROCKET WIDTH « B »	CHAIN LINE « C »
65	110	21.5	<b>40</b>
68	110	21.5	<b>40</b>
68	120	24	<b>42,5</b>
70	120	24	<b>42,5</b>

# TANDEM CHAIN LINE

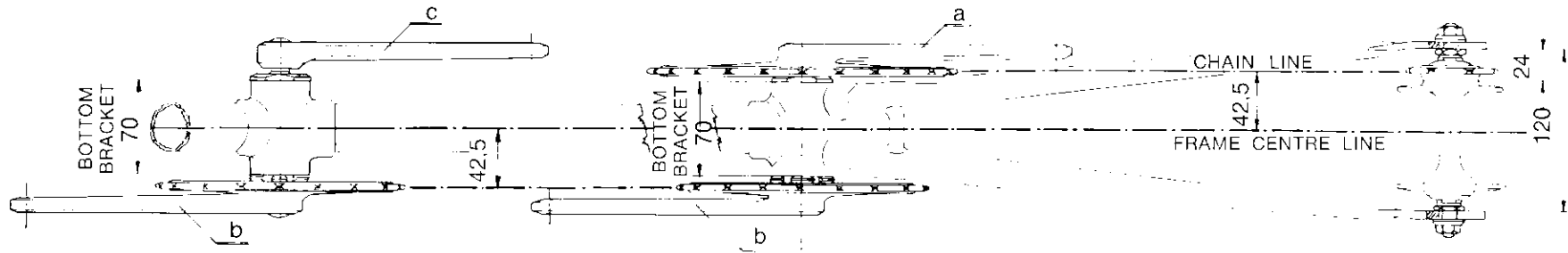

- a TRACK RIGHT HAND STANDARD CRANK
- b TRACK RIGHT HAND CRANK WITH LEFT HAND THREAD
- c TRACK LEFT HAND CRANK WITH RIGHT HAND THREAD

